



HP LaserJet 1600



Index:

- 1. Covers Simplex model**
- 2. Covers Duplex model**
- 3. Internal assemblies (1 of 3)**
- 4. Internal assemblies (2 of 3)**
- 5. Internal assemblies (3 of 3)**
- 6. Internal components 4 of 4**



1-Covers Simplex model

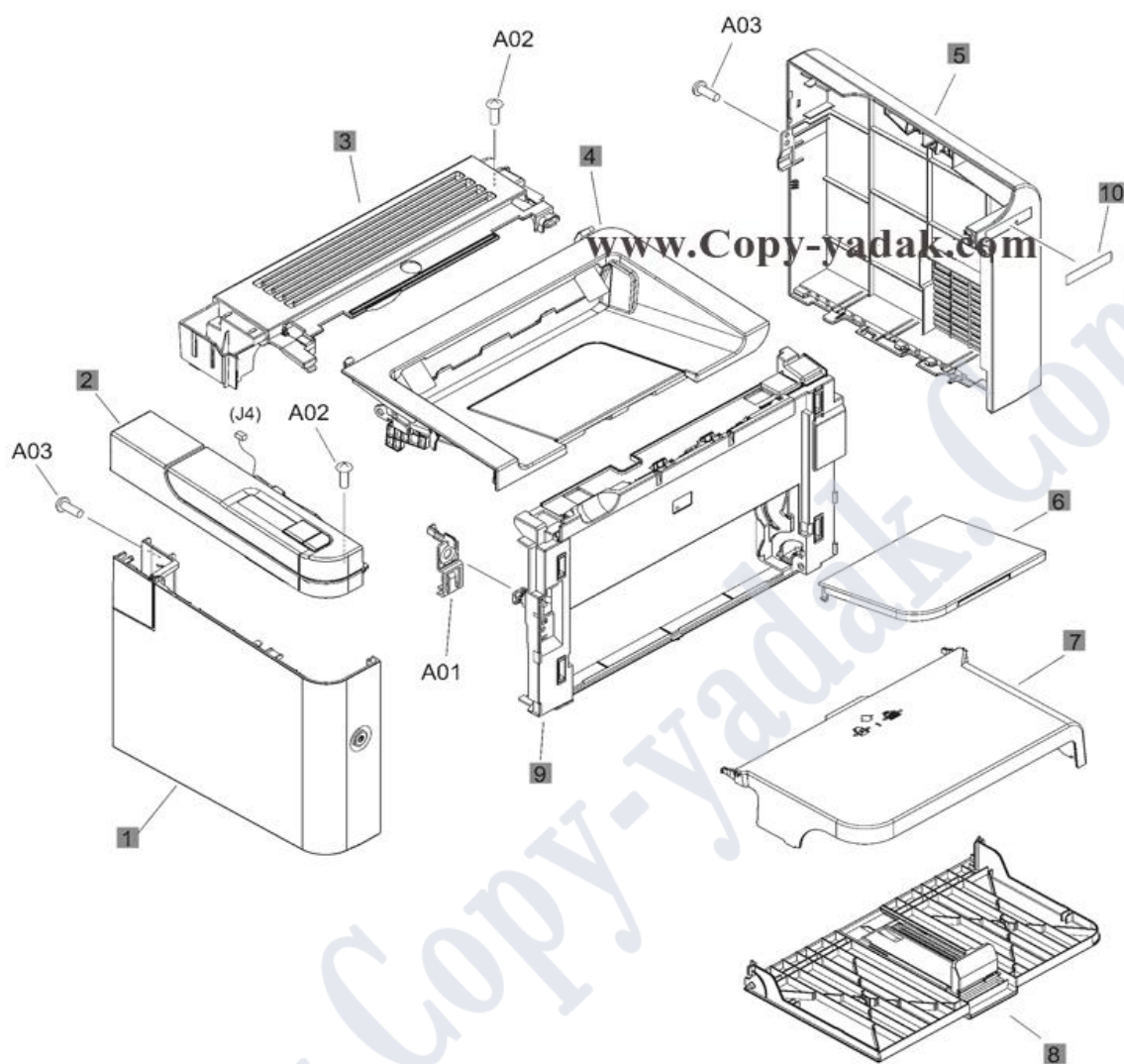

Parts Number		Description
1	RM1-7533-000CN	Left cover
10	RC3-0623-000CN	Plate, name
2	RM1-7530-000CN	Control-panel assembly
3	RC2-9464-000CN	Cover, face-down
4	RM1-7528-000CN	Cartridge door
5	RC2-9462-000CN	Cover, right
6	RM1-7499-000CN	Paper delivery tray
7	RC2-9582-000CN	Cover, dust
8	RM1-7535-000CN	Paper pickup tray
9	RL1-2871-000CN	Cover, front



2- Covers Duplex model

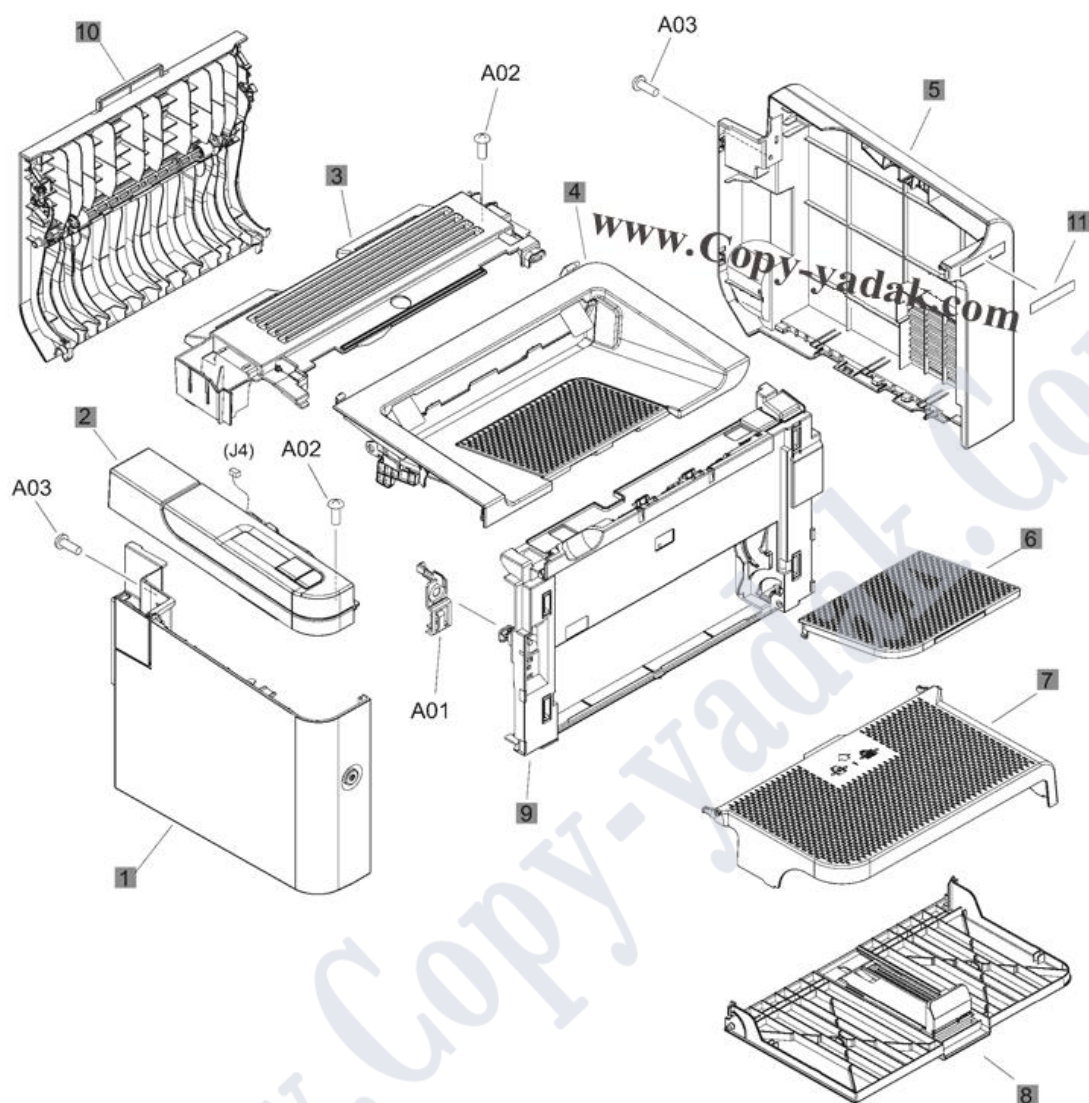

Parts Number		Description
1	RM1-7532-000CN	Left cover
10	RM1-7526-000CN	Duplexing door assembly
11	RC3-0622-000CN	Plate, name
2	RM1-7529-000CN	Control-panel assembly
3	RC2-9436-000CN	Cover, face-down
4	RM1-7527-000CN	Cartridge door
5	RC2-9458-000CN	Cover, right
6	RM1-7498-000CN	Paper delivery tray
7	RC2-9578-000CN	Cover, dust
8	RM1-7534-000CN	Paper pickup tray
9	RL1-2870-000CN	Cover, front

3- Internal assemblies (1 of 3)

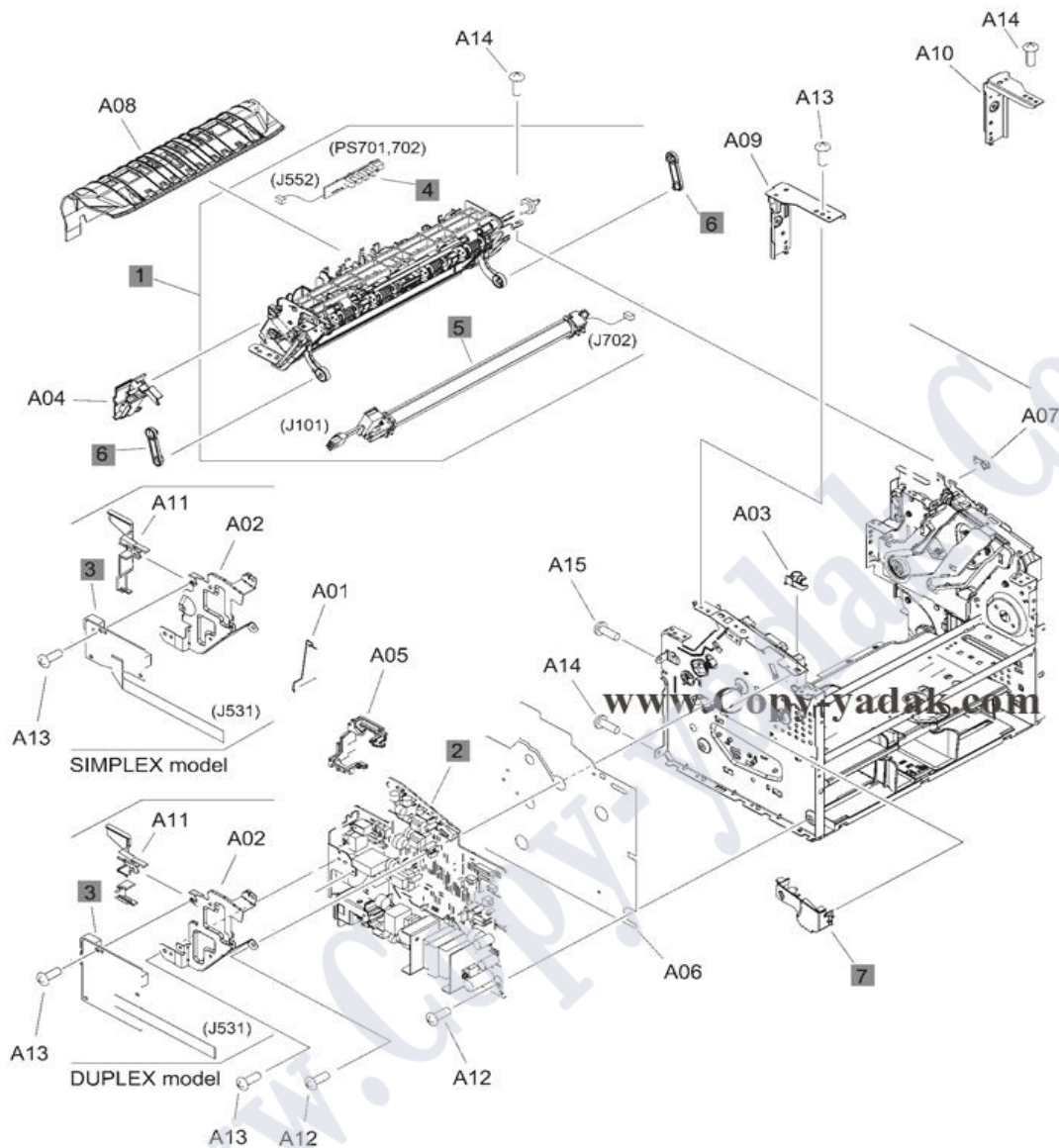

Parts Number		Description
1	RM1-7546-000CN	Fuser assembly (110 V)
1	RM1-7547-000CN	Fuser assembly (220 V)
2	RM1-7615-000CN	Engine controller PCA (110 V)
2	RM1-7616-000CN	Engine controller PCA (220 V)
3	RM1-7623-000CN	Formatter PCA, duplex model
3	RM1-7622-000CN	Formatter PCA, simplex model
4	RM1-7440-000CN	Delivery sensor PCA assembly
5	RM1-7541-000CN	Fuser film assembly (110 V)
5	RM1-7542-000CN	Fuser film assembly (220 V)
6	RC2-9512-000CN	Link, pressure release
7	RM1-7531-000CN	Switch lever assembly

4- Internal assemblies (2 of 3)

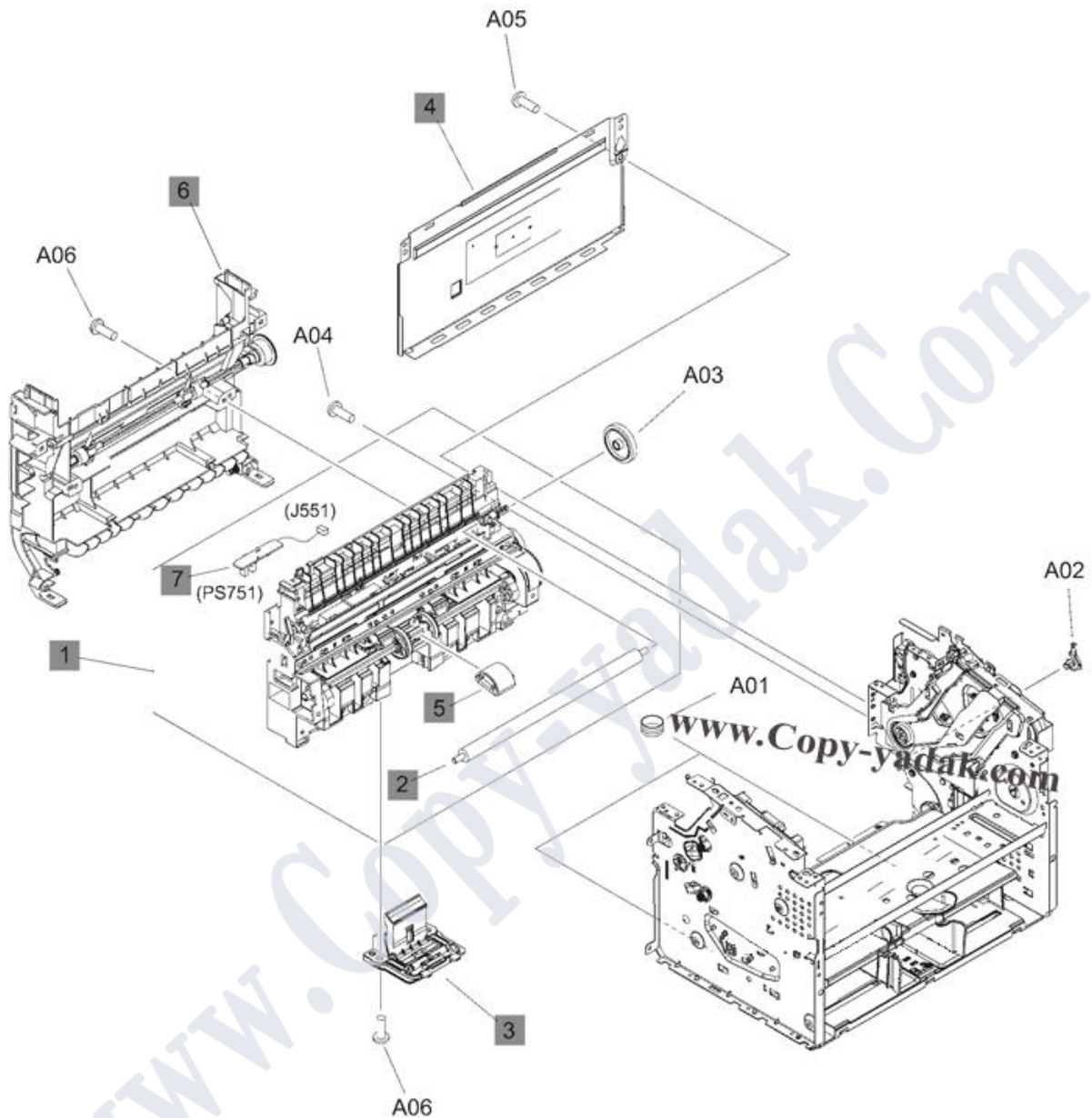

Parts Number Description		
1	RM1-7517-000CN	Paper pickup assembly, simplex model
1	RM1-7516-000CN	Paper pickup assembly, duplex model
2	RM1-4023-000CN	Transfer roller
3	RM1-4227-000CN	Separation pad
4	RC2-9583-000CN	Panel, rear, simplex model
5	RL1-1497-000CN	Roller, pickup
6	RM1-7525-000CN	Duplex frame assembly, duplex model
7	RM1-7618-000CN	Paper pickup sensor PCA assembly

5- Internal assemblies (3 of 3)

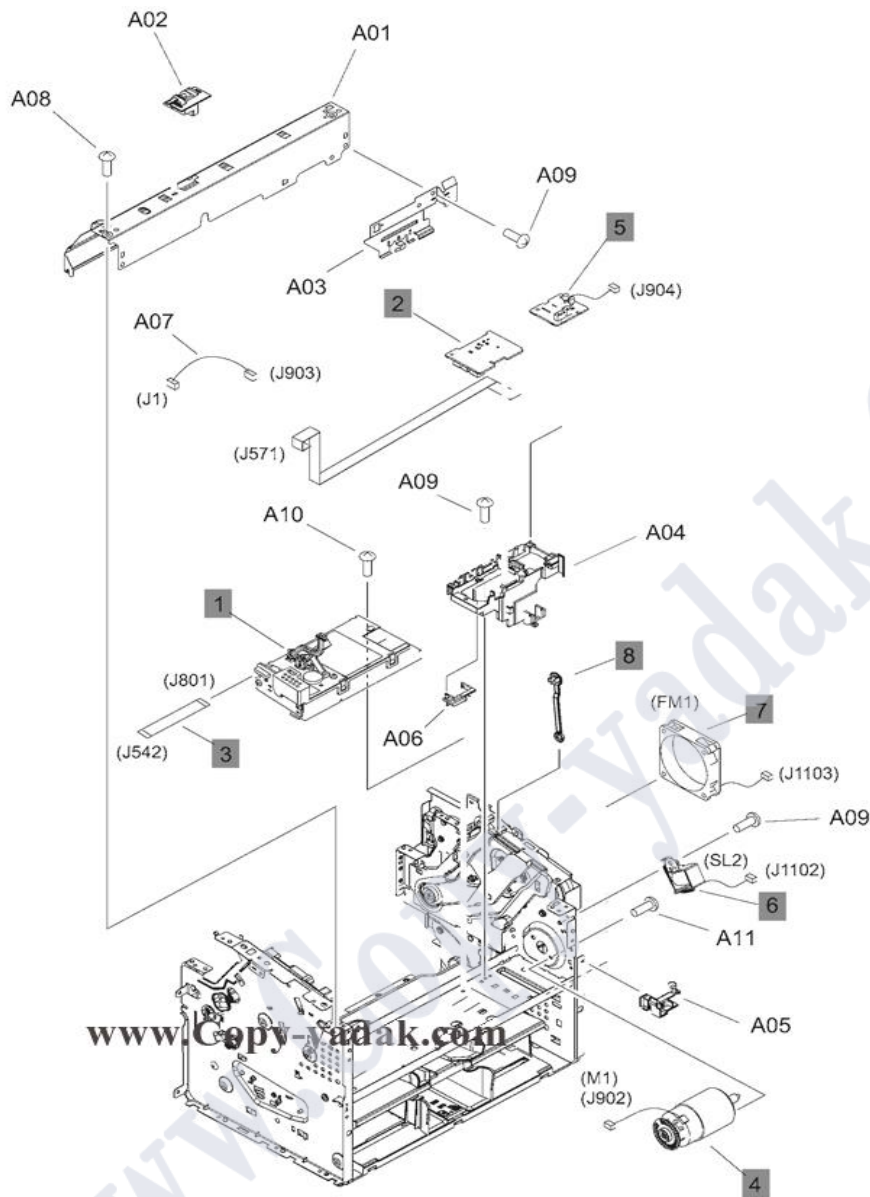

Parts Number Description		
1	RM1-7561-000CN	Laser/scanner assembly, simplex model
1	RM1-7560-000CN	Laser/scanner assembly, duplex model
2	RM1-7619-000CN	Motor PCA
3	RM1-7739-000CN	Cable, flat
4	RM1-7544-000CN	Motor, DC24V
5	RM1-7620-000CN	Duplex PCA, duplex model
6	RK2-0420-000CN	Solenoid, duplex model
7	RK2-3238-000CN	Fan, duplex model
8	RC2-9425-000CN	Link, cartridge door



6-Internal components 4 of 4

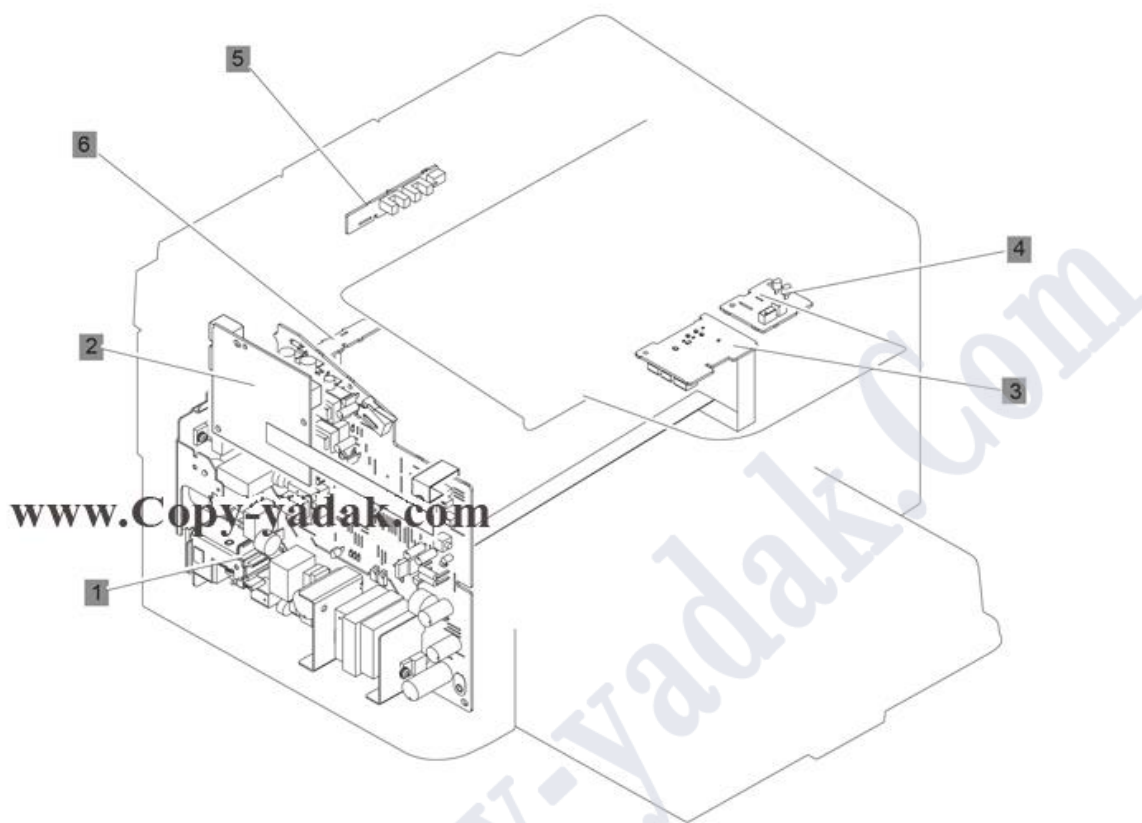

Parts Number		Description
1	RM1-7615-000CN	Engine controller PCA (110 V)
1	RM1-7616-000CN	Engine controller PCA (220 V)
2	RM1-7622-000CN	Formatter PCA, simplex model
2	RM1-7623-000CN	Formatter PCA, duplex model
3	RM1-7502-000CN	Motor, DC24V
4	RM1-7620-000CN	Duplex PCA, duplex model
5	RM1-7440-000CN	Delivery sensor PCA assembly
6	RM1-7618-000CN	Paper pickup sensor PCA assembly