

SHARP PARTS GUIDE

CODE:00ZARM206/025

DIGITAL COPIER

Revised Edition

AR-M206
AR-M161
AR-M207
AR-M207E
AR-M162
AR-M162E
AR-M165

MODEL

CONTENTS

- | | |
|------------------------------------|--|
| 1 Exteriors | 14 Delivery frame unit |
| 2 Operation panel section | 15 TC case unit |
| 3 Side door unit | 16 250 sheets tray unit |
| 4 Optical unit | 17 Packing material & Accessories |
| 5 2nd,3rd mirror unit | 18 2nd Tray extensor
[AR-M206/AR-M207/AR-M207E] |
| 6 Middle frame unit | 19 2nd Tray paper feeding unit
[AR-M206/AR-M207/AR-M207E] |
| 7 Process unit | ■ Index |
| 8 DV cartridge unit | |
| 9 Fusing unit | |
| 10 Main driving unit | |
| 11 Base plate unit 1 | |
| 12 Base plate unit 2 | |
| 13 Manual paper feeding multi unit | |

DEFINITION

- Rank A : Maintenance parts, and consumable parts which are not included in but closely related to maintenance parts
Rank B : Performance/function parts (sensors, clutches, and other electrical parts), consumable parts
Rank E : Unit parts including PWB
Rank D : Preparation parts (External fitting, packing, parts packed together)
Rank C : Parts other than the above (excluding sub components of PWB)

Because parts marked with "△" is indispensable for the machine safety maintenance and operation, it must be replaced with the parts specific to the product specification.

- Other than this Parts Guide, please refer to documents Service Manual (including Circuit Diagram) of this model.
- Please use the 13 digit code described in the right hand corner of front cover of the document, when you place an order.
- For U.S. only-Use order codes provided in advertising literature. Do not order from parts department.

[NOTE]

- * There parts are supplied by SMF

<Note for use of the revised Parts Guide>

- Interchangeability of parts is expressed by No1~6 as shown in the table below.

<Interchangeability>

1	Interchangeable.
2	Current type can be used in place of new type. New type cannot be used in place of current type.
3	Current type cannot be used in place of new type. New type can be used in place of current type.
4	Not interchangeable.
5	Interchangeable if replaced with same types of related parts in use.
6	Others.

- New & Addition, Change, Abolition, and Quantity change are expressed with the marks shown in the table below.

<Change of Division>

New & Addition	△
Change	↻
Abolition	⊠
Q'antity (increase) /Others	☆
Q'antity (decrease)	★
Correction	Ⓒ

- Running Change of Effective Time is expressed as R/C.

<Effective Time>

R / C	Running Change
-------	----------------

1 Exteriors

NO.	PARTS CODE	Inter-change	PRICE RANK	NEW MARK	PART RANK	DESCRIPTION	TR No.	Effective time
1	GCOVH0010QSE5		BD		D	OC cover [AR-M161/AR-M162/AR-M162E/AR-M165]		
	GCOVH0010QSE6	1	BD		D	OC cover [AR-M161/AR-M162/AR-M162E/AR-M165]		07/10 R/C
	PCUSS0023QSZ1		AV		C	OC mat [AR-M161/AR-M162/AR-M162E/AR-M165]		
2	PCUSS0023QSZ2	1	AV		C	OC mat [AR-M161/AR-M162/AR-M162E/AR-M165]		06/08 mid
	CHNG-0007QSO2		AM		C	OC hinge [AR-M161/AR-M162/AR-M162E/AR-M165]		
3	CHNG-0007QSO6	1	AL	N	C	OC hinge [AR-M161/AR-M162/AR-M162E/AR-M165]		07/08 R/C
4	XEBS740P10000		AA		C	Screw(4x10)		
5	GCAB-0104QSZZ		AL		D	Delivery left cabinet		
6	GCOV-0064QSZ1		AP		D	Rear cover [AR-M161/AR-M162/AR-M206/AR-M207(U.S.A,Canada)]		
	GCOV-0064QSZZ		AP		D	Rear cover [AR-M162(Australia,New Zealand,Taiwan)/AR-M162E/AR-M165/AR-M207(Europe,Australia,New Zealand,Taiwan)/AR-M207E]		
7	CFIX-0024QSO7		AK		D	Glass fixing plate		
	CFIX-0024QSI3	1	AK		D	Glass fixing plate		- R/C
8	PGLSP0003QSZZ		BA		B	Table glass		
9	PSHEZ0220QSZ1		AK		C	Sheet		
	GCAB-0068QSZZ		AV		D	Front cabinet		
10	GCAB-0068QSZ1	1	AV		D	Front cabinet		- R/C
	CCOV-0046QSI7		AY		D	Front cabinet cover [AR-M162/AR-M162E]		
	CCOV-0046QSI1M	1	AY		D	Front cabinet cover [AR-M162/AR-M162E]		- R/C
	CCOV-0046QSI23		AY		D	Front cabinet cover [AR-M165]		
	CCOV-0046QSI1T	1	AY		D	Front cabinet cover [AR-M165]		- R/C
	CCOV-0046QSI18		AY		D	Front cabinet cover [AR-M207/AR-M207E]		
	CCOV-0046QSI1N	1	AY		D	Front cabinet cover [AR-M207/AR-M207E]		- R/C
12	CARMP0010QSO3		AD		C	Hinge arm		
	CARMP0010QSO4		AD		C	Hinge arm		08/02
	GCOV-0048QSZZ		AM		D	Rear cabinet cover		
13	GCOV-0048QSZ1	1	AM		D	Rear cabinet cover		- R/C
	LX-BZ0759FCP3		AA		C	Screw(3x6)		
	LX-BZ0088QCPZ		AA		C	Screw(3x6)		07/09
	GCAB-0071QSI3		AU		D	Left cabinet		
15	GCAB-0071QSI4	1	AU		D	Left cabinet		- R/C
17	XHBS730P08000		AB		C	Screw(3x8)		
	GCAB-0102QSI1		AZ		D	Rear cabinet		
18	GCAB-0102QSI3	3	AZ		D	Rear cabinet [Form change]		06/10
19	PGIDM0110QSZZ		AG		C	Hinge guide L		
20	XHBS730P06000		AC		C	Screw(3x6)		
21	PGIDM0111QSZZ		AG		C	Hinge guide R		
22	LFIX-0026QSZZ		AH		C	OC glass fixing		
	GCAB-0015QSEB		AU		D	Right cabinet		
23	GCAB-0015QSEC	1	AU		D	Right cabinet		06/04
	GCAB-0015QSED	1	AU		D	Right cabinet		- R/C
24	XEBS740P10000		AA		C	Screw(4x10)		
25	LX-BZ0759FCPZ		AC		C	Screw(3x6)		
26	CGIDM0133QSO1		AG		C	OR guide unit		
27	GCAB-0101QSI1		AL		D	Front right cabinet (U.S.A,Canada)		
	CCAB-0101QSO1		AN		D	Front right cabinet (Except U.S.A,Canada)		
36	PSHEZ0088QSI1		AD		C	Table glass sheet F		
41	PMLT-0039QSZZ		AC		C	OC cushion [AR-M161/AR-M162/AR-M162E/AR-M165]		
44	TLABH0458QSZZ		AF		D	Operation label		
49	TLABZ0058QSZZ		AD		D	Class 1 label (Except U.S.A,Canada)		
50	LX-WZ1003HCZZ		AA		C	Poly slider(T=0.5)		
51	TLABH0322QSZZ		AD		D	Scanning direction label		
	TLABG0401QSZZ		AR		D	Energy star label (Hong Kong)		
52	TLABZ4047FCZZ		AC		D	Energy star label (Europe)		
	TLABZ5148FCZZ	1	AC		D	Energy star label (Europe)		06/07
	TLABZ5148FCZZ		AC		D	Energy star label (U.S.A,Canada,Australia,New Zealand)		
53	LX-BZ3008SCPS		AA		C	Screw(3x8)		
54	TLABM0520QSZZ		AE		D	Imagery label (U.S.A,Canada)		
55	TLABZ0059QSZZ		AE		D	ECP label (U.S.A,Canada)		
59	TCAUA0770FCZZ		AB		D	Service caution label		
501	CCOVH0010RS56		BK		E	OC cover unit [AR-M161/AR-M162/AR-M162E/AR-M165]		
502	CFIX-0024RS56		BC		E	Table unit		

1 Exteriors

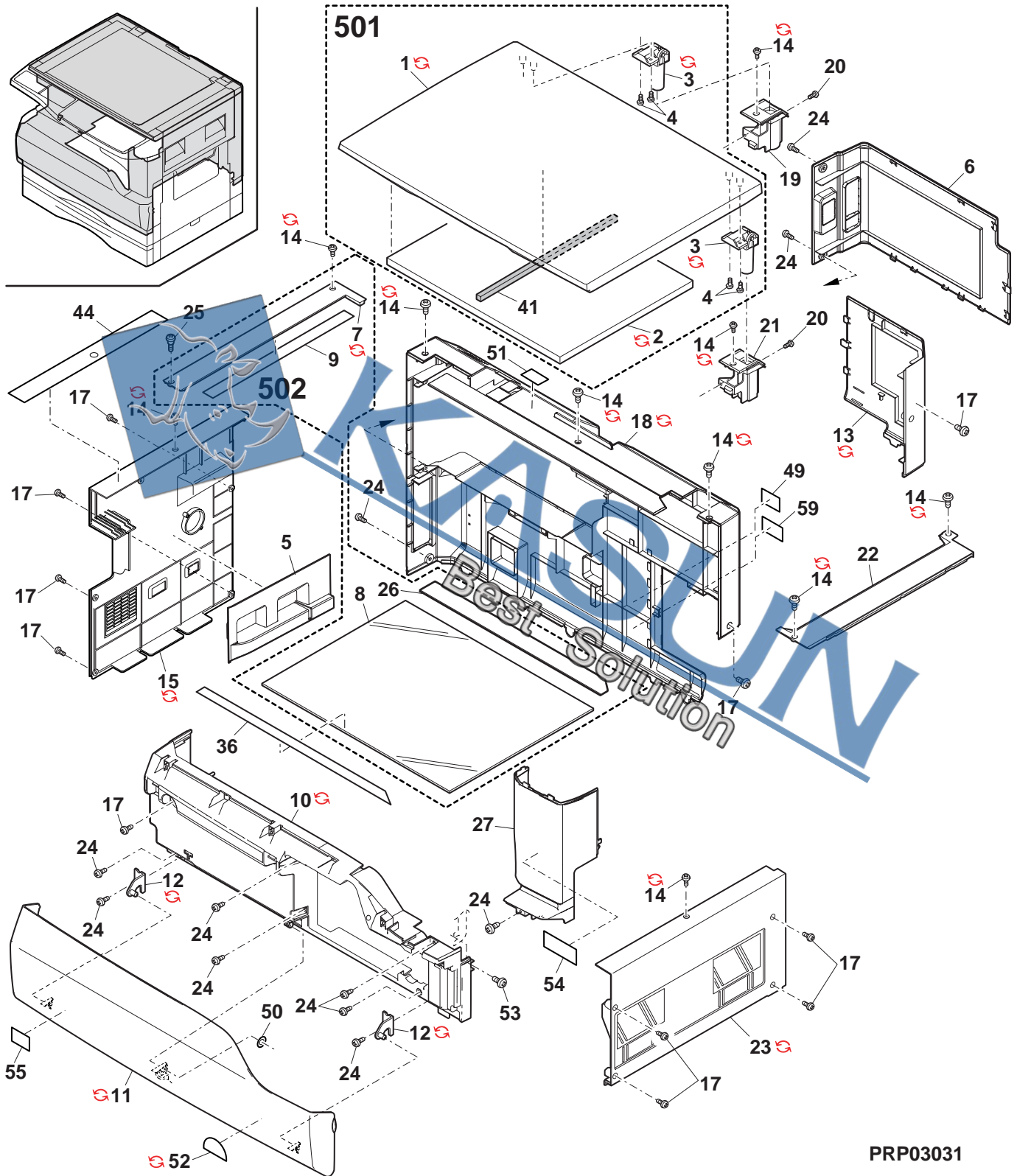

PRP03031

2 Operation panel section

NO.	PARTS CODE	Inter-change	PRICE RANK	NEW MARK	PART RANK	DESCRIPTION	TR No.	Effective time
1	LX-BZ0750FCPZ		AA		C	Screw(3x6)		
2	LX-BZ0088QSPZ	1	AA		C	Screw(3x6)		07/09
3	GCAB-0103QSZZ		AS		D	Operation panel cabinet		
4	JBTN-0087QSZZ		AC		C	Interruption key		
5	JBTN-0088QSZZ		AD		C	Cross key		
6	JBTN-0085QSZZ		AE		C	Operation key		
7	CBTN-0086QS01		AG		C	Mode key		
8	CBTN-0060QS01		AK		C	Ten key		
9	CBTN-0061QS01		AE		C	Start key AS		
10	PFI LZ0012QSZZ		AC		C	Start key LG		
11	CBTN-0062QS01		AF		C	CA key		
12	LBOSZ0061QSZZ		AC		C	Cross key boss		
13	CPWBF0177QSE2		AZ		E	KEY PWB		
14	DHAI-0485QSZZ		AD		C	Key A harness		
15	GCOV-0063QSZZ		AK		D	Operation panel cover		
16	GCAB-0100QSZZ		AS		D	Operation panel bottom		
17	XEBS730P08000		AC		C	Screw(3x8)		
	CPNLH0042QS07		BA		D	Main deco. panel(S-E) [AR-M161/AR-M162(Australia,New Zealand)]		
	CPNLH0042QS06		AW		D	Main deco. panel(S-E) [AR-M162(U.S.A,Canada)/AR-M162E]		
	CPNLH0043QS10		AY		D	Main deco. panel(D-E) [AR-M165/AR-M207](Germany,Switzerland)		
	CPNLH0043QS09		AX		D	Main deco. panel(D-E) [AR-M165/AR-M206/AR-M207](Other Countries)		
	CPNLH0043QS08		AX		D	Main deco. panel(D-E) [AR-M207(U.S.A,Canada)/AR-M207E]		
	CPNLH0042QS08	-	BC		D	Main deco. panel [Missing parts code][AR-M162(Taiwan)]		1st lot
	CPNLH0043QS11	-	BC		D	Main deco. panel [Missing parts code][AR-M207(Taiwan)]		1st lot
18	XEBS730P10000		AC		C	Screw(3x10)		
19	LPLTP0379QSZZ		AF		C	LCD panel		
20	DHAI-0479QSZZ		AG		C	OP-MCU harness		
	PCOVP1468FCPZ		AD		C	FAX battery cover [AR-M162E/AR-M207E]		
21	PCOVP1468FCZ0		AD		C	FAX battery cover [Other Model]		
	PCOVP1468FCPZ	3	AD		C	FAX battery cover [Unleaded correspondence][Other Model]		06/02
22	DHAI-0487QSZZ		AC		C	FAX key harness		
23	HPNLH0041QSZZ		AH		C	FAX dummy		
24	PFI LZ0015QSZZ		AC		C	INFO cover		
25	XEBS730P08000		AC		C	Screw(3x8)		
26	XHBS730P08000		AB		C	Screw(3x8)		
32	CPWBX0176QSE2		BP		E	LCD PWB[Include No.101] (U.S.A,Canada)		
	CPWBX0176QSE3		BP	N	E	LCD PWB[Include No.101] (Except U.S.A,Canada,Denmark,Finland,Norway)		
33	DUNTK0534QSZZ		BL		E	LCD unit		
101	VHI29L04058QS		AS		B	LCD Flash ROM[Contained in No.32] (U.S.A,Canada)		
	VHI29L0800LQS		AT	N	B	LCD Flash ROM[Contained in No.32] (Except U.S.A,Canada,Denmark,Finland,Norway)		
501	CBOX-0007QSH7		BU		E	LCD box unit (U.S.A,Canada)		
	CBOX-0007QSH9		BV		E	LCD box unit (Denmark,Finland,Norway)		
	CBOX-0007QSi3		BV		E	LCD box unit (Poland,Hungary,Czech,Republic,Slovakia,Greece)		
	CBOX-0007QSi1		BV		E	LCD box unit (Taiwan)		
	CBOX-0007QSH8		BV		E	LCD box unit (Other Countries)		
901	(Unit)							
	CCAB-0103RS57		BZ		E	Operation panel unit [AR-M161/AR-M162(Australia,New Zealand)]		
	CCAB-0103RS53		BZ		E	Operation panel unit [AR-M162(U.S.A,Canada)/AR-M162E]		
	CCAB-0103RS56		BZ		E	Operation panel unit [AR-M207(U.S.A,Canada)/AR-M207E]		
	CCAB-0103RS60		BZ		E	Operation panel unit [AR-M165/AR-M207](Denmark,Finland,Norway)		
	CCAB-0103RS59		BZ		E	Operation panel unit [AR-M165/AR-M207](Germany,Switzerland)		
	CCAB-0103RS58		BZ		E	Operation panel unit [AR-M165/AR-M206/AR-M207](Other Countries)		

2 Operation panel section

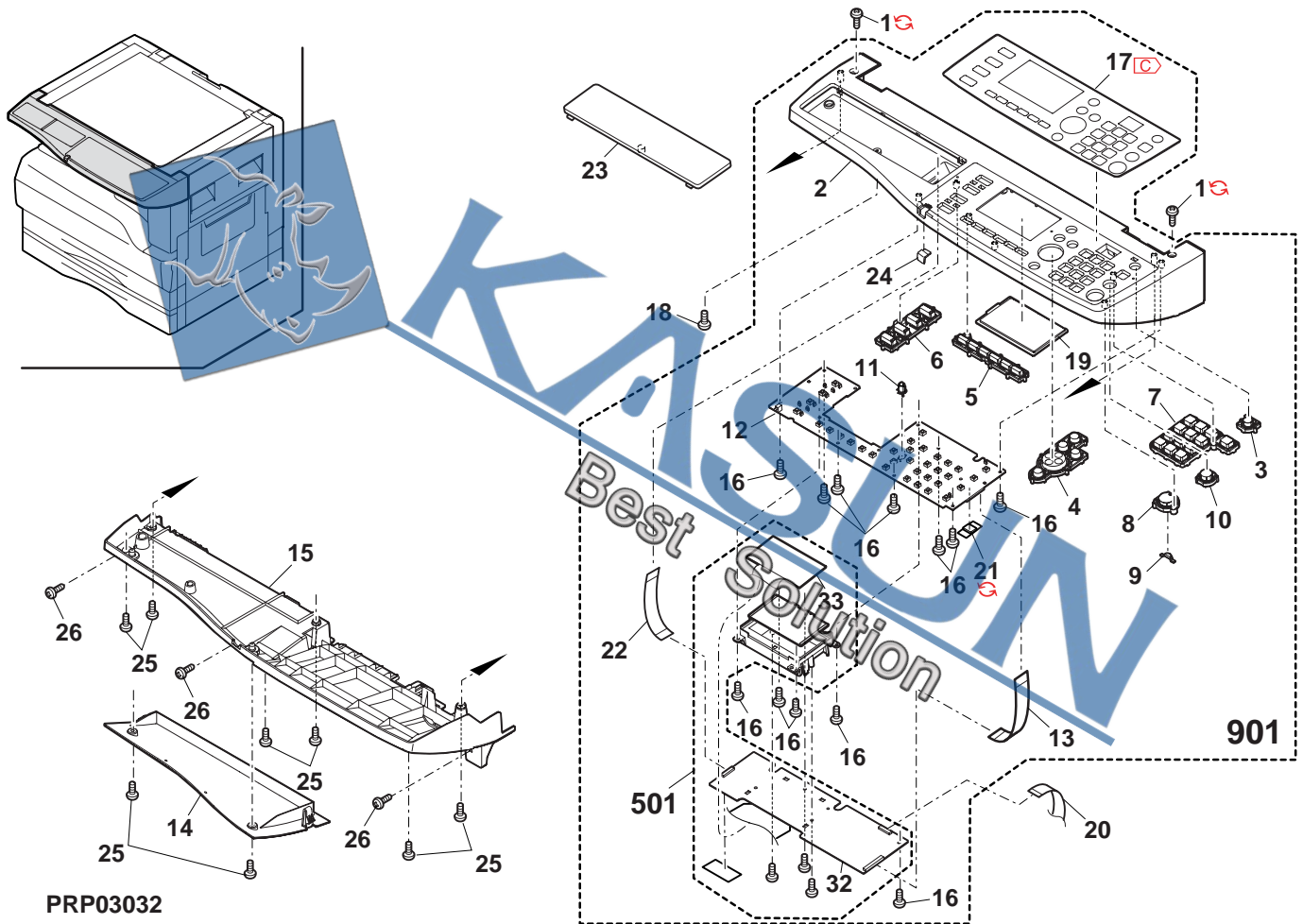

3 Side door unit

NO.	PARTS CODE	Inter-change	PRICE RANK	NEW MARK	PART RANK	DESCRIPTION	TR No.	Effective time
1	GDOR-0004QSZ1		AQ		D	Right door		
	GDOR-0004QSZ2	1	AQ		D	Right door		- R/C
2	LRALP0004QSZ2		AH		C	Right door rail		
	LRALP0004QSZ3	1	AH	N	C	Right door rail		07/08 R/C
3	XHBS730P10000		AD		C	Screw(3x10)		
	LPLTM0092QSZZ		AF		C	Rail reinforce plate		
4	LPLTM0092QSZ1	1	AE		C	Rail reinforce plate		08/02
5	XHBS730P14000		AA	N	C	Screw(3x14)		
6	LPLTM0091QSZZ		AE		C	Inner reinforce plate R		
	LPLTM0091QSZ1	3	AE		C	Inner reinforce plate R	[Form change]	06/04 R/C
7	XEBS730P10000		AC		C	Screw(3x10)		
8	LPLTM0090QSZZ		AE		C	Inner reinforce plate F		
	LPLTM0090QSZ1	3	AE		C	Inner reinforce plate F	[Form change]	06/04 R/C
9	MSPRC0085QSZZ		AE		C	TC case GND spring		
10	LFRM-0016QSZ5		AQ		C	Right door inner N		
	LFRM-0016QSZ6	1	AQ		C	Right door inner N		06/04
11	XHBS730P16000		AA	N	C	Screw(3x16)		
13	MSPRC0084QSZ1		AD		C	BC I/F electrode spring		
14	MSPRC0083QSZ1		AD		C	TC I/F electrode spring		
15	LHLDZ0033QSZ1		AF		C	TC terminal I/F holder		
16	MSPRC0082QSZ1		AC		C	Pressure spring		
18	CHLDZ0030RS55		AY		E	TC unit		
21	NROLP0036QSZZ		AP		B	DUP transport roller	[AR-M165/AR-M206/AR-M207/AR-M207E]	
22	LBSHZ0030FCZZ		AC		C	M bushing C	[AR-M165/AR-M206/AR-M207/AR-M207E]	
23	XRESP40-06000		AA		C	E type ring(E4)	[AR-M165/AR-M206/AR-M207/AR-M207E]	
24	XPSSJ20-07000		AA		C	Spring pin(φ2-7)	[AR-M165/AR-M206/AR-M207/AR-M207E]	
25	NGERH0074QSZZ		AD		C	DUP roller driving gear	[AR-M165/AR-M206/AR-M207/AR-M207E]	
26	LPLTM0102QSZZ		AD		C	DUP roller earth plate	[AR-M165/AR-M206/AR-M207/AR-M207E]	
27	MSPRT0141QCA0		AB		C	FU PSV spring	[AR-M165/AR-M206/AR-M207/AR-M207E]	
28	NROLP1122FQZZ		AF		C	PS upper roller	[AR-M165/AR-M206/AR-M207/AR-M207E]	
31	MSPRC0319QSZZ		AB		C	Right door knob spring		
32	JKNBZ0008QSZZ		AE		C	Right door knob		
	(Unit)							
901	CDOR-0004RS51		BC		E	Side door unit(Without No.16,18)	[AR-M161/AR-M162/AR-M162E]	
	CDOR-0004RS52		BD		E	Side door unit(Without No.16,18)	[AR-M165/AR-M206/AR-M207/AR-M207E]	

3 Side door unit

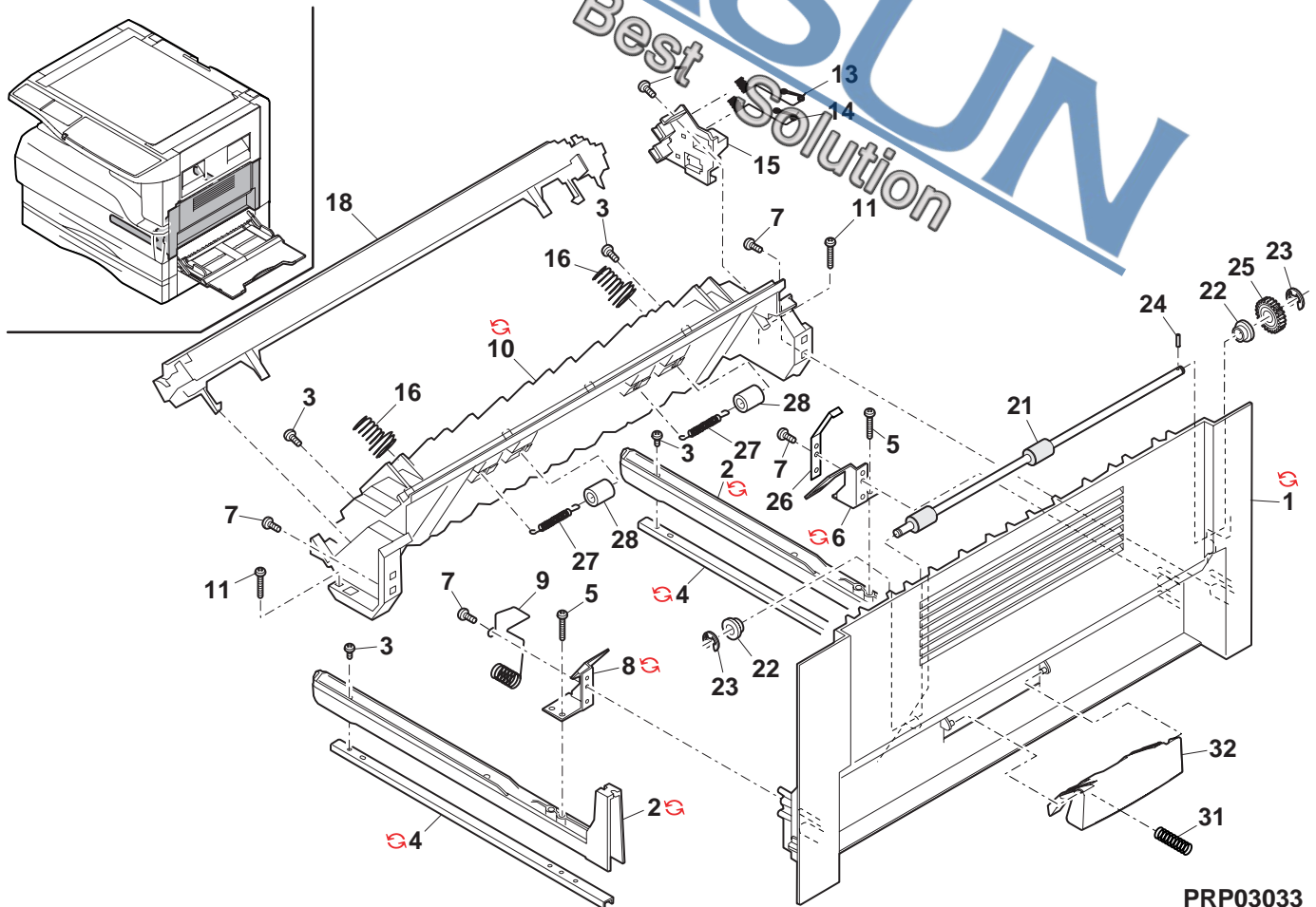

PRP03033

4 Optical unit

NO.	PARTS CODE	Inter-change	PRICE RANK	NEW MARK	PART RANK	DESCRIPTION	TR No.	Effective time
1	PWIR-0006QSPZ		AZ		C	MB wire F		
2	CMIR-0008QS37		BA		E	2nd,3rd mirror unit		
3	PWIR-0005QSP1		AZ		C	MB wire R		
4	LHLDZ0109QSZZ		AD		C	Wire holder		
5	XBPS740P06K00		AA	N	C	Screw(4x6K)		
6	XHBS730P06000		AC		C	Screw(3x6)		
7	PCASZ0010QSZZ		AL		C	Dark box		
8	CLNS-0006RS52		BY		E	Lens unit		
9	DHAI-0342QSZZ		AG		C	CCD harness		
10	DHAI-0488QSZZ		AD		C	OC cover harness		
11	LBNDJ0043FCP1		AB		C	Cable band [AR-M162E/AR-M207E]		
	LBNDJ0043FCZ1		AA		C	Cable band [Other Model]		
	LBNDJ0043FCP1	3	AB		C	Cable band [Unleaded correspondence][Other Model]		06/02
12	LPLTM0384QSZZ		AE		C	Original detection shield plate (AB series)		
13	PSHEZ0500QSZZ		AD		C	Manuscript detection shield sheet		
14	LBNDJ0071FCZZ		AC		C	Cable band(RSG-100)		
15	PMLT-0109QSZZ		AC		C	Cushion ORG1		
16	PMLT-0110QSZZ		AC		C	Cushion ORG2		
18	NPLYZ0016QSZZ		AF		C	Pulley		
19	NPLYZ0006QSZZ		AD		C	L pulley		
19	NPLYZ0006QSZ1	1	AD	N	C	L pulley		06/12 R/C
20	XRESP40-05000		AA		C	E type ring(E4)		
21	PGUMS0004QSZZ		AA		C	Table glass cushion		
22	CPWBF0147QSF3		AL		E	MHPS PWB		
23	XBBS730P08000		AA		C	Screw(3x8)		
25	LHLDZ0104QSZZ		AD		C	CL lead holder		
26	LX-BZ0004QSPZ		AB		C	Screw(Red)		
27	LRALM0007QSZ1		AG		C	MB-B rail R		
28	MSPRC0040QSZZ		AB		C	MB drive spring		
29	XBPS730P05000		AA	N	C	Screw(3x5K)		
30	RMOTS0041QSZZ		BA		B	Mirror motor [AR-M162E/AR-M207E]		
	RMOTS0041QSZZ		BA		B	Mirror motor [Other Model]		
	RMOTS0041QSPZ	3	BA		B	Mirror motor [Unleaded correspondence][Other Model]		06/02
31	XBPS740P16KS0		AB		C	Screw(4x16KS)		
32	CPLTM0312QS02		AK		C	Mirror motor fixing plate		
33	PGUMS0002QSZZ		AL		C	Protection rubber		
34	NGERH0165QSZZ		AE		C	Mirror motor idle gear		
35	LX-WZ0017GCZZ	1	AC		C	Washer		- R/C
	LX-WZ0017GCZ1		AC		C	Washer		
36	XRESP70-08000		AA		C	E type ring(E3)		
37	NBLTT0037QSZZ		AL		B	Winder drive gear		
38	XRESP50-06000		AA		C	E type ring(E5)		
39	NBRGP0012QSZZ		AC		C	Winder bearing R		
40	NPLYZ0032QSZZ		AK		C	Winder drive shaft pulley		
41	LX-BZ0324FCPZ		AA		C	Screw(3x4)		
42	LX-BZ0049FCPZ		AB		C	Screw(4x6) [AR-M162E/AR-M207E]		
	LX-BZ0049FCZZ		AB		C	Screw(4x6) [Other Model]		
43	NPLYZ0031QSZZ		AL		C	Winder pulley		
44	NSFTZ0071QSPZ		AQ		C	Winder drive shaft		
46	NBRGP0011QSZZ		AC		C	Winder bearing F		
47	LRALM0006QSZZ		AG		C	MB-B rail F		
48	CDAIU0012QS13		BF		D	Optical base plate		
49	LHLDZ0116QSZZ		AD		C	Paper fixing holder		
50	LX-BZ0750FCPZ	1	AA		C	Screw(3x6)		07/09
	LX-BZ0088QSPZ		AA		C	Screw(3x6)		
52	PSHEZ0440QSZZ		AC		C	Optical front sheet		
53	PSHEZ0448QSZZ		AA		C	Optical base plate bottom sheet B		
56	PMLT-0033QSZZ		AC		C	Optical cushion D		
58	PSHEZ0152QSZZ		AD		C	Optical bottom sheet		
59	RCORF0018QSZZ		AR		C	Ferrite core		
60	PSHEZ0209QSZZ		AB		C	CCD harness protect sheet A		
62	LPFTF0004QSZZ		AB		C	Winder flange		
63	PSHEZ0418QSZZ		AC		C	Optical FR front sheet		
64	LX-BZ0039FCZZ		AB		C	Screw(4x4)		
66	PSHEZ0420QSZZ		AC		C	OP harness protect sheet		
67	PSHEZ0426QSZZ		AB		C	OP harness protect sheet B		
70	PTPE-0051QSZZ		AC		C	OP harness fixing tape		
71	PSHEZ0273QSZZ		AB		C	CCD harness sheet		
72	PSHEZ0217QSZZ		AC		C	CCD harness protect sheet B		
79	PTPE-0050QSZZ		AA		C	Core fixing tape		
80	LPLTM0314QSZZ	1	AC		C	Wire support plate		08/02
	LPLTM0314QSZ1		AC		C	Wire support plate		
81	DHAI-0332QSZZ		AE		C	CL harness		
82	RINV-0002QSZZ		AU		E	Inverter		
83	LFIX-0023QSZZ		AC		C	Harness fixing plate		
85	MSLI-0138FCZZ		AC		C	Slider		
86	MSPRP2825FCZZ		AC		C	Mirror spring		
87	PCUSF0334FCZZ		AP		C	Mirror cushion		
88	PCUSU0203FCZZ		AE		C	Cushion		
89	PMIR-0164FCZZ		AP		B	1st mirror		

4 Optical unit

NO.	PARTS CODE	Inter-change	PRICE RANK	NEW MARK	PART RANK	DESCRIPTION	TR No.	Effective time
90	PREFL0005QSZZ		AH		C	Lamp reflector		
91	RLMPD0033QSZZ		AS		B	Lamp		
92	LDAIU0030QSZZ		AS		D	Lamp base		
93	XEBS830P06000		AB		C	Screw(3x6)		
96	TLABZ4335FCZZ		AB		D	High pressure cautions label		
97	PREFL0006QSZZ		AK		C	Sub reflector		
99	MARMP0054QSZ1		AD	N	C	Arm		
101	PCOVP0075QSZZ		AE		D	Harness cover		
102	XNES730-24000		AA	N	C	Nut(M3)		
103	VHPGP2D03// - 18		AZ		B	Photo sensor(GP2D03)	(Inch series)	
	VHPGP2D07// - 1		BA		B	Photo sensor(GP2D07)	(AB series)	
	VHPGP2D07// - 18	3	BA	N	B	Photo sensor [Unleaded solder correspondence]	(AB series)	06/03
104	DHAI-0484QSZZ		AL		C	OC detection harness	(Inch series)	
	DHAI-0483QSZZ		AM		C	OC detection harness	(AB series)	
105	LHLDW1009ACZZ		AA		C	Clamp		
106	XHBS730P06000		AC		C	Screw(3x6)		
107	VHPGP2D032// - 18		BA		B	Photo sensor(GP2D032)	(Inch series)	
	RSNSZ0001QSZZ		BA		B	Photo sensor(GP2D071)	(AB series)	
	RSNSZ0001QSPZ	3	BA	N	B	Photo sensor [Unleaded solder correspondence]	(AB series)	06/02
108	XBPS730P08X00		AA	N	C	Screw(3x8X)		
109	LPLTP0230QSZZ		AF		C	Open/close sensor fixing plate		
110	VHPGP1S73P+ - 18		AF		B	Photo transistor(GP1S73P)		
111	MSPRD0232QSZZ		AB		C	Return spring		
112	MLEVP0077QSZZ		AC		C	Open/Close actuator		
113	LCRA-0002QSZZ		AC		C	Mini clump		
114	PSHEZ0218QSZZ		AC		C	Edge protect sheet A		
115	PSHEZ0219QSZZ		AC		C	Edge protect sheet B		
116	LX-BZ0077QSZZ		AB		C	Screw		
117	PSHEZ0254QSZZ		AC		C	Optical bottom sheet		
118	PSHEZ0499QSZZ		AF		C	Manuscript detection shield sheet	(Inch series)	
119	RCORF0018QSZZ		AR		C	Ferrite core	(Taiwan, South Africa)	08/01
501	CREFL0005RS56		BD		E	Copy lamp unit		

4 Optical unit

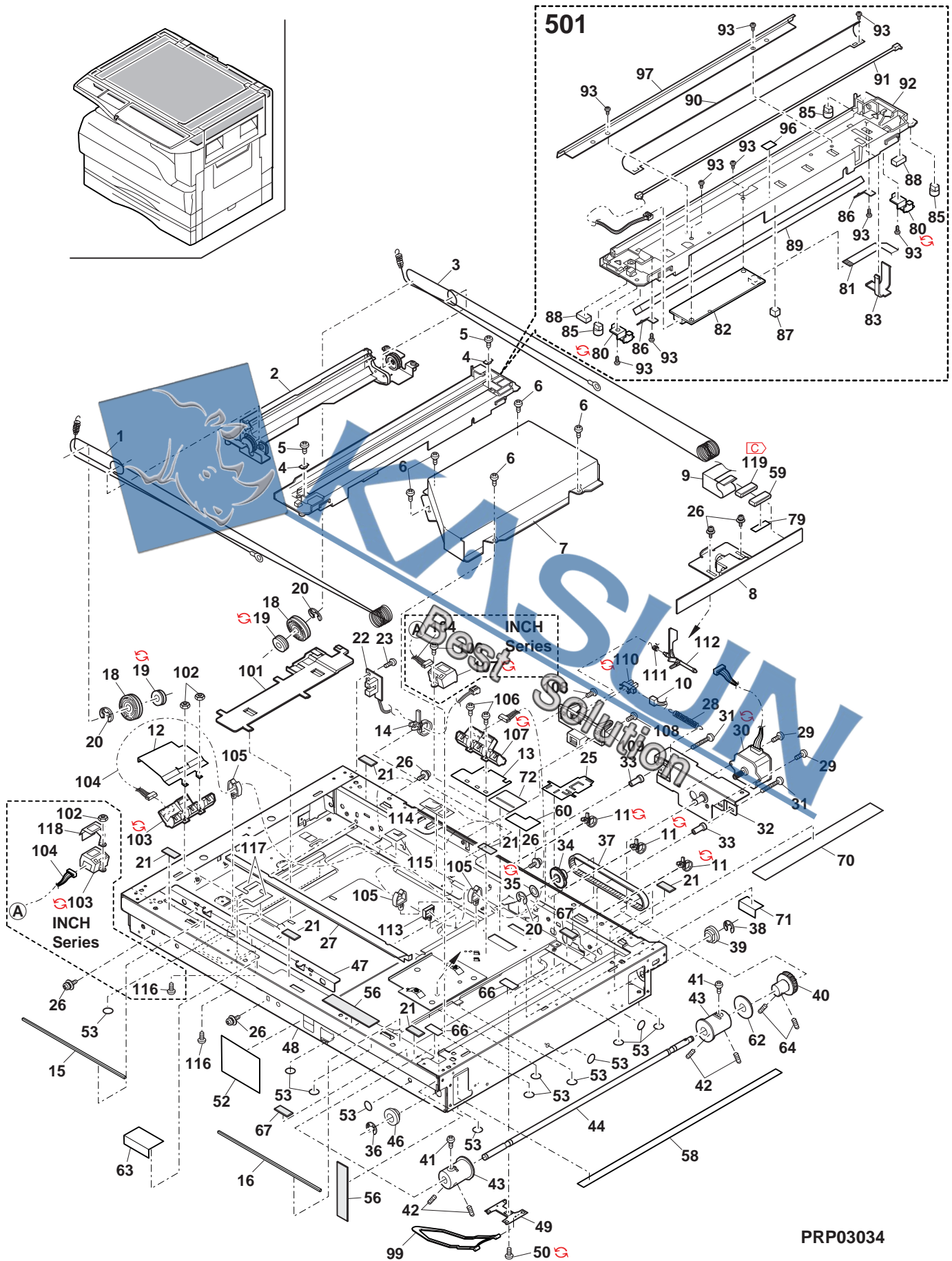

PRP03034

5 2nd,3rd mirror unit

NO.	PARTS CODE	Inter-change	PRICE RANK	NEW MARK	PART RANK	DESCRIPTION	TR No.	Effective time
1	LHLDZ0044QSZ2		AN		C	2nd,3rd mirror holder		
3	XBPS740P06KS0		AB	N	C	Screw(4x6KS)		
4	NPLYZ0017QSZZ		AE		C	W pulley		
5	LHLDZ0013QSZZ		AD		C	CL guide holder		
7	MSLi-0138FCZZ		AC		C	Slider		
8	LX-BZ0335FCPZ		AB		C	Screw(4x6)(Red)		
9	CPLTM0156QS03		AH		C	Pulley fixing plate R		
10	PCUSS0009QSZZ		AA		C	MB-B cushion R		
11	LFiX-0284FCZZ		AC		C	2nd,3rd mirror fixing plate F		
12	PMiR-0008QSZ1		BA		B	2nd,3rd mirror		
13	CPLTM0155QS03		AH		C	Pulley fixing plate F		
14	PCUSS0201FCZZ		AA		C	MB-B cushion		
15	PSPAZ0011QSZZ		AD		C	Mirror spacer		
16	PMLT-0084QSZZ		AB		C	2nd,3rd mirror cushion		
17	LX-WZ0001GCZZ		AB		C	Washer		
(Unit)								
901	CMiR-0008QS37		BA		E	2nd,3rd mirror unit		

5 2nd,3rd mirror unit

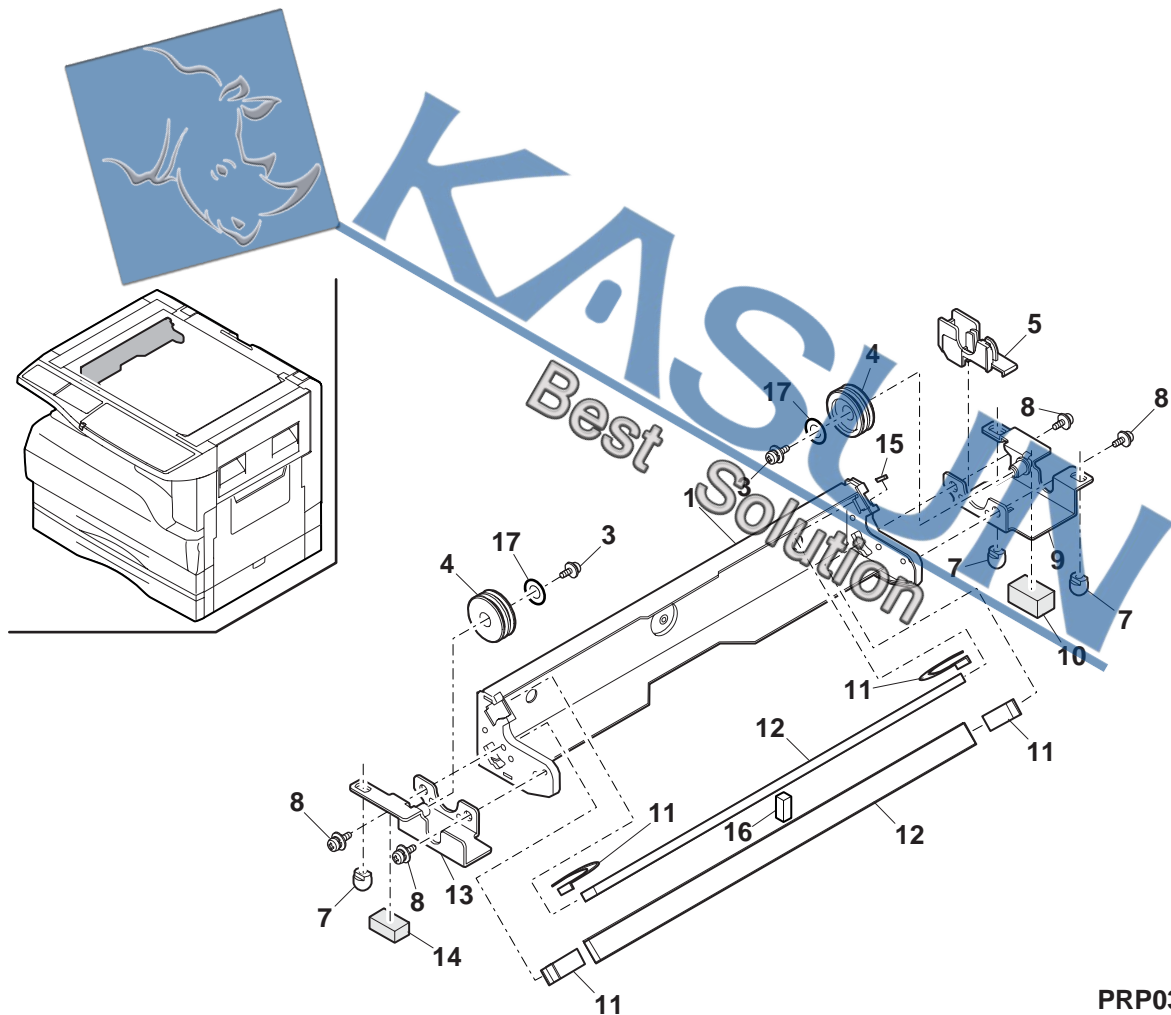

6 Middle frame unit

NO.	PARTS CODE	Inter-change	PRICE RANK	NEW MARK	PART RANK	DESCRIPTION	TR No.	Effective time
1	XEPS723P12000		AA	N	C	Screw(2.3x12)		
2	CSW-M0007RS55		AS		B	Interlock switch unit		
3	NCPL-0007QSZ1		AC		C	Hopper coupling		
4	MSPRC0024QSZZ		AA		C	Hopper spring		
4	MSPRC0024QSZ1	1	AC		C	Hopper spring		07/09
5	RMOTD0035QSPZ		AX		B	Toner motor		
5	RMOTD0035QSP1	1	AZ		B	Toner motor		06/08 R/C
6	XEBS730P10000		AC		C	Screw(3x10)		
7	DUNTK0343RS12		BR		E	LSU[Include No.101]		
8	DHAI-0322QSZZ		AS		C	DEV harness		
9	XBPS30P06ES0		AA		C	Screw(3x6ES)		
10	CHAI-0109RS52		AN		C	GB-MCFB harness unit		
11	CHAI-0107RS52		AM		C	MC harness unit		
12	MSPRD0104QSZZ		AC		C	HV terminal spring (case)		
13	MSPRD0103QSZZ		AC		C	HV terminal spring (grid)		
14	MSPRD0102QSZZ		AC		C	HV terminal spring (saw)		
15	LHLDZ0038QSZ1		AH		C	High voltage terminal holder		
16	XEBS730P08000		AC		C	Screw(3x8)		
18	XEBS730P10000		AC		C	Screw(3x10)		
21	LHLDZ0039QSZZ		AE		C	High voltage terminal holder TC		
22	LPLTM0067QSZZ		AC		C	TC terminal plate		
22	LPLTM0067QSZ1	1	AC		C	TC terminal plate		08/02
23	XEBS730P06000		AA		C	Screw(3x6)		
24	DHAI-0106QSZZ		AK		C	BC harness		
25	DHAI-0108QSZZ		AH		C	TC harness		
26	MSPRC0278QSZZ		AC		C	PS pressure spring		
27	XRESP40-06000		AA		C	E type ring(E4)		
28	NSFTZ0021QSP1		AN		C	PS follower roller shaft		
29	NKOM-0001QSZZ		AD		C	PS collar(φ12)		
30	MSPRD0139QSZZ		AB		C	PS earth spring		
31	XEBS730P06000		AA		C	Screw(3x6)		
33	LBOSZ1508FCZZ		AG		C	Cam boss A2		
34	PPiPP0174FCZZ		AC		C	Pipe C		
35	MSPRC0106QSZZ		AF		C	PS clutch spring		
36	XPSSJ20-07000		AA		C	Spring pin(φ2-7)		
37	NGERH0062QSZZ		AK		C	Clutch gear(32T)		
38	NBRGC0018QSZZ		AD		C	Bearing E		
39	XRESP60-08000		AA		C	E type ring(E6)		
40	NROLP0032QSP2		AT		B	PS transport roller		
41	JKNBZ0010QSZZ		AD		C	PS knuckle		
42	XBPS730P10KS0		AB	N	C	Screw(3x10ks)		
46	LFRM-0024QSZ3		BC		C	Middle frame		
46	LFRM-0024QSZ5	5	BA		C	Middle frame [With No.102,9-63,101]	DCE582	05/08
47	LPI NS0300FCZZ		AD		C	DV guide pin (Inch series)		
47	LPI NS0301FCZZ		AD		C	DV guide pin (AB series)		
49	PSHEZ0056QSZZ		AC		C	PS rear guide sheet		
51	LANGT0003QSZ1		AC		C	SRU fixing angle		
53	TCAUH0007QSZZ		AD		D	Laser caution label		
53	TCAUH0021QSZZ	-	AD		D	Laser caution label [Missing parts code][AR-M162/AR-M207(Taiwan)]		1st lot
54	LBNDJ0013FCZ1		AE		C	Cable band		
55	LPLTM0149QSZZ		AD		C	Connector fixing plate		
56	LX-BZ0020QSPZ		AB		C	Screw		
57	DHAI-0333QSZZ		AL		C	SRU harness		
60	LSTPP0014QSZZ		AC		C	Right door stopper		
61	MSPRD0298QSZZ		AD		C	Stopper spring		
62	LHLDZ0099QSZZ		AC		C	Stopper holder		
63	DHAI-0321QSZZ		AH		C	LSU harness		
64	XEPS730P14X00		AB	N	C	Screw(3x14X)		
65	XHBS730P06000		AC		C	Screw(3x6)		
66	LX-WZ0198FCZZ		AA		C	Poly slider(T=0.13)		
66	LX-WZ0198FCZ1	1	AA		C	Poly slider(T=0.13)		- R/C
67	LX-WZ1003HCZZ		AA		C	Poly slider(T=0.5)		
68	MSPRC0339QSZZ		AD		C	PS brake spring		
101	RMOTN0022QSPZ		BL		B	Polygon motor[Contained in No.7]		
102	LPLTM0389QSZZ	5	AK		C	Fusing fixing plate [With No.46,9-63,101]		05/08

6 Middle frame unit

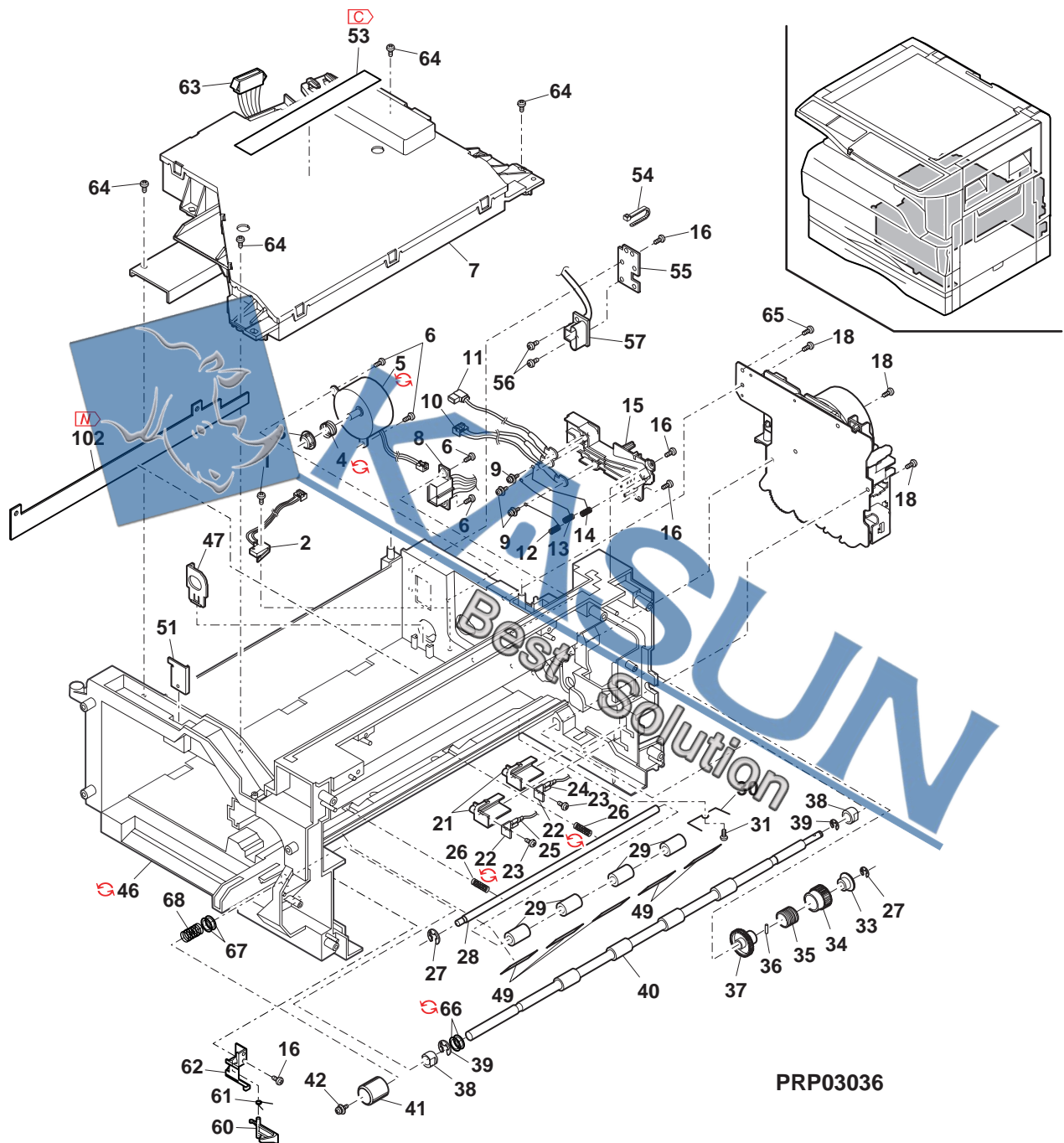

- 7-1 -

7 Process unit

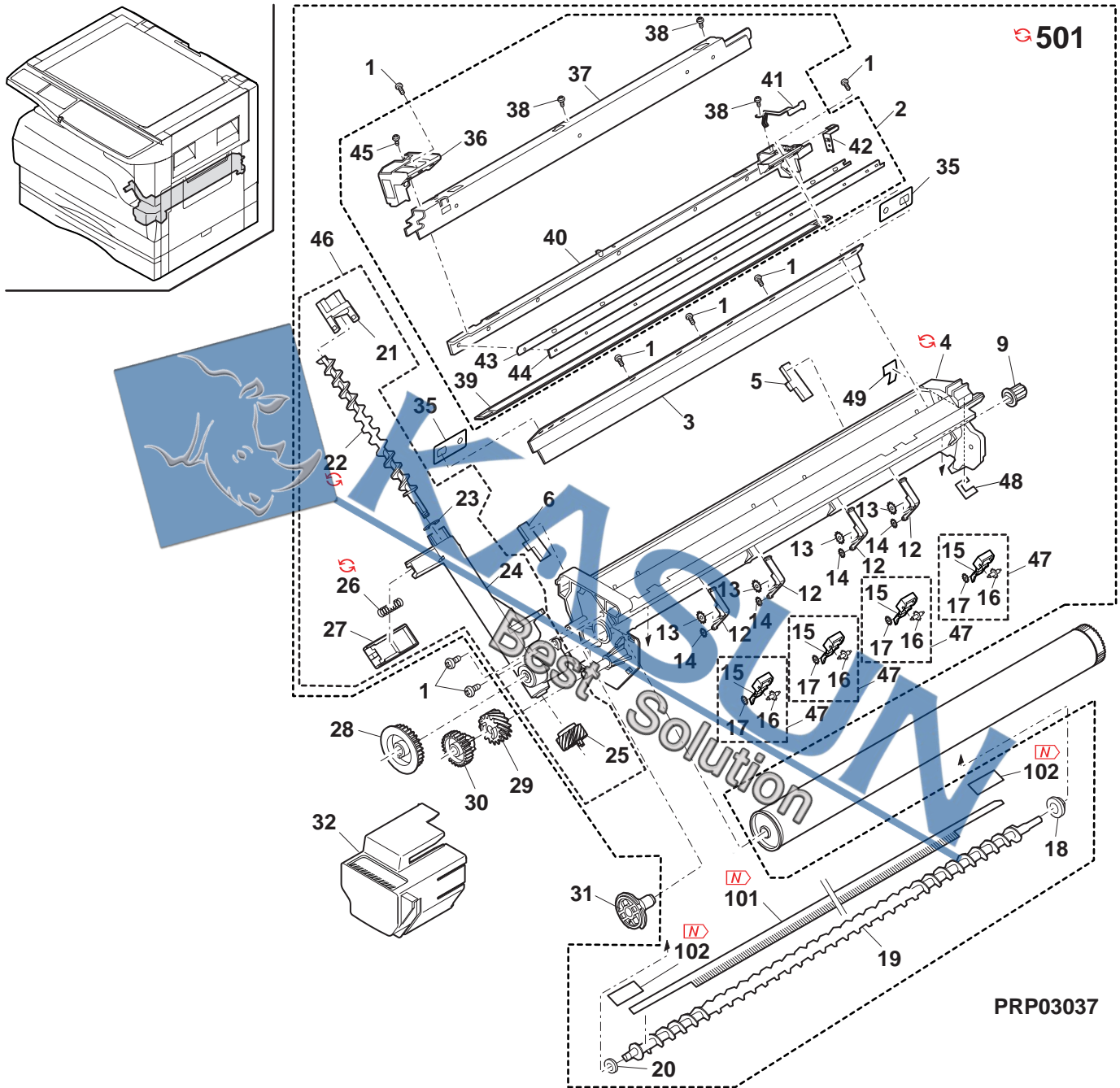

- 8-1 -

8 DV cartridge unit

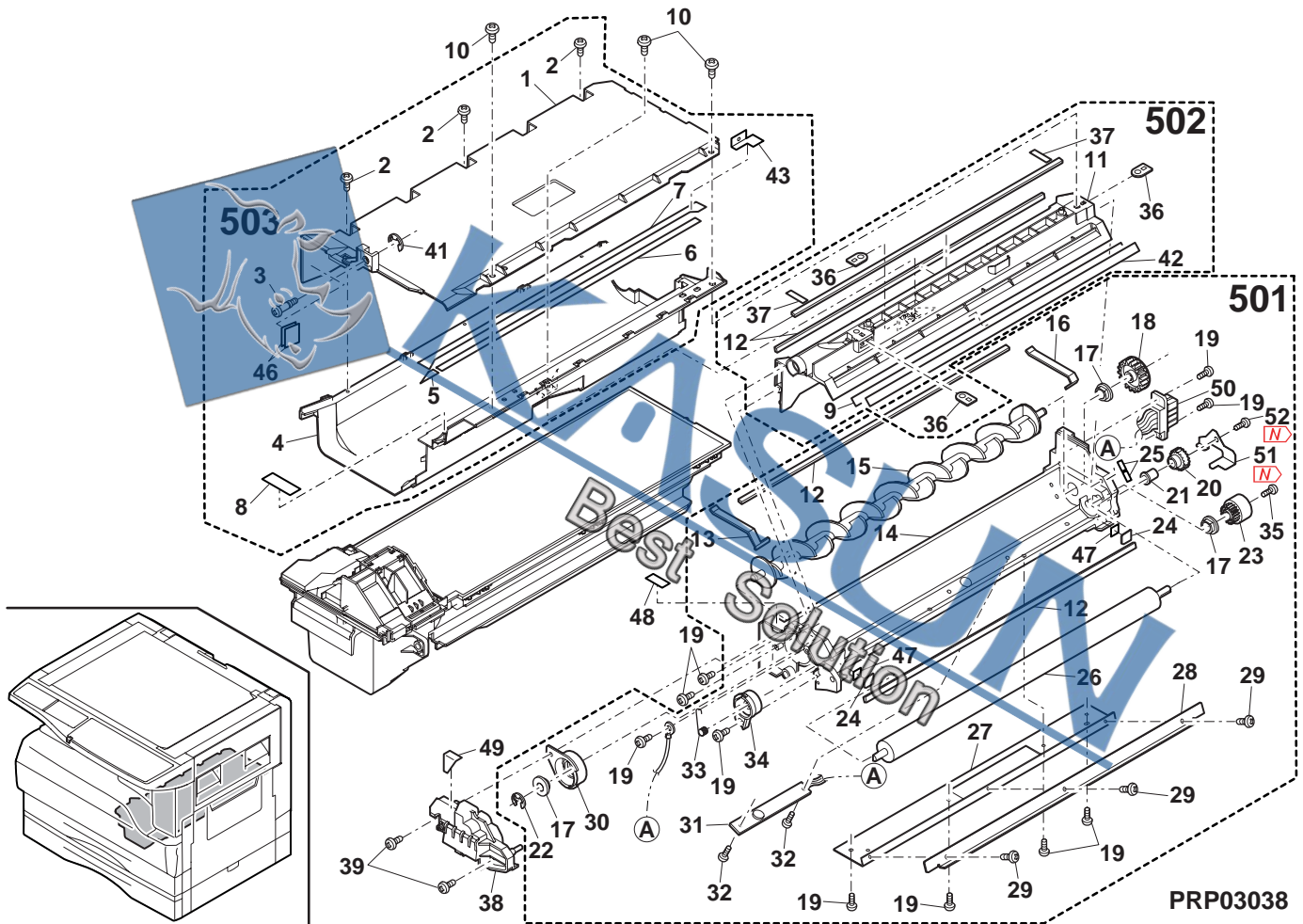

9 Fusing unit

NO.	PARTS CODE	Inter-change	PRICE RANK	NEW MARK	PART RANK	DESCRIPTION	TR No.	Effective time
1	XBPS730P06KS0		AB	N	C	Screw(3x6KS)		
2	RTHM-0001QSZZ		AM		B	Thermostat		
3	DHAI-0184QSZ1		AE		C	Fusing harness		
4	XHBS730P06000		AC		C	Screw(3x6)		
5	PCOVP0029QSZ6		AT		D	Fusing cover		
5	PCOVP0029QSZ7	1	AT		D	Fusing cover		07/06 R/C
6	RLMPU0015QSZZ		BA		B	Heater lamp (120V series)		
6	RLMPU0016QSZZ		BA		B	Heater lamp (230V series)		
6	RLMPU0018QSZZ	-	BA		B	Heater lamp [Missing parts code][AR-M162/AR-M207(Taiwan)]		1st lot
7	LSTPP0116FCZZ		AA		C	Roller stopper A2		
8	NBRGP0567FCZZ		AG		A	Fusing bearing		
9	XBPS730P08KS0		AB	N	C	Screw(3x8KS)		
10	CFRM-0017QS01		AH		C	Fusing frame F		
10	CFRM-0017QS03	1	AH		C	Fusing frame F		08/01 R/C
11	NROLi0030QSZZ		BC		A	Upper heat roller		
12	CFRM-0018QS01		AH		C	Fusing frame R		
12	CFRM-0018QS03	1	AH		C	Fusing frame R		08/01 R/C
13	NGERH0540FCZ3		AD		B	Fusing gear(45T)		
14	LHLDZ0034QSZZ		AF		C	Lamp holder		
14	LHLDZ0034QSZ1	1	AF		C	Lamp holder		08/02
15	XBPS730P10KS0		AB	N	C	Screw(3x10KS)		
16	RDTCT0005QSZ1		AN		B	Thermistor		
17	LPLTM0050QSZ1		AM		C	Fusing joint plate		
18	MSPRT0086QSZZ		AB		C	Upper pawl pressure spring		
20	PGiDM0034QSZZ		AL		C	Fusing rear paper guide		
21	XEBS730P06000		AA		C	Screw(3x6)		
22	XBBS730P06000		AC		C	Screw(3x6)		
23	LPLTP0051QSZZ		AD		C	PG fixing plate		
25	PGiDH0131QSZZ		AU		C	Fusing front paper guide		
25	PGiDH0131QSZ2	1	AU		C	Fusing front paper guide		06/07
27	NROLR0031QSZ1		BB		A	Pressure roller		
28	NBRGP0260FCZ1		AD		C	Pressure bearing N		
29	XRESP30-06000		AA		C	E type ring(E3)		
30	LX-BZ0013QSP1		AD		C	Screw(3x7)		
31	MSPRP0087QSZZ		AC		C	PG earth spring		
32	MSPRT0303QSZZ		AD		C	Pressure spring B		
33	MLEVP0018QSZ1		AF		C	Fusing pressure lever F		
34	MLEVP0019QSZ3		AE		C	Release lever F		
35	MLEVP0020QSZ3		AE		C	Release lever R		
36	MLEVP0017QSZ1		AF		C	Fusing pressure lever R		
37	PTME-0020GCZ1		AF		A	Separator (pawl)		
39	TLABH0062QSZZ		AE		D	High temperature caution label		
39	TLABH0155QSZ1	-	AE		D	High temperature caution label [Missing parts code][AR-M162/AR-M207(Taiwan)]		1st lot
40	LFRM-0036QSZZ		AS		C	Fusing lower frame		
41	LPLTP0060QSZZ		AM		C	Reverse gate		
41	LPLTP0060QSZ5	1	AM	N	C	Reverse gate		06/04
42	MLEVP0026QSZZ		AE		C	DMC actuator		
42	MLEVP0026QSZ3	1	AE	N	C	DMC actuator		06/06 R/C
43	MSPRD0117QSZZ		AB		C	Rotation spring		
44	MSPRD0118QSZ1		AB		C	Actuator return spring		
46	PSHEZ0105QSZZ		AC		C	Fusing sheet		
48	LX-WZ0313FCZZ		AA		C	Washer		
49	VRHRST2HB157K		AD		C	Resistor(1/2W 150MΩ ±10%)		
50	PBRSR0004QSZ1		AD		B	Discharge brush		
51	PTME-0014QSZZ		AK		A	Lower separator pawl		
52	MSPRD0122QSZZ		AB		C	Separator pawl spring R		
53	MSPRD0121QSZZ		AB		C	Separator pawl spring F		
54	XWHS730-05070		AA	N	C	Washer (AB series)		
55	LX-WZ0001QSZZ		AC		C	Separator pawl washer		
57	TLABH0364QSZZ		AA		D	Green label		
58	LX-WZ7021SCPZ		AA		C	Washer		
59	CPLTM0255QS01		AS		C	FU felt fixing plate		
60	PGiDM0102QSZZ		AD		C	Fusing front guide F (Except Taiwan AB series)		
60	PGiDM0103QSZZ		AD		C	Fusing front guide R (Except Taiwan AB series)		
61	PGiDM0103QSZ1	3	AD		C	Fusing front guide R [Productivity improvement] (Except Taiwan AB series)		07/01 R/C
62	XHBS730P08000		AB		C	Screw(3x8)		
63	XEBS740P12000		AA		C	Screw(4x12)		
63	XEBS740P14000	5	AB		C	Screw(4x14) [With No.101,6-46,102]		05/08
101	LX-BZ0080QSZZ	5	AC		C	Fusing fixing screw [With No.63,6-46,102]		05/08
102	TLABH0685QSZZ	-	AD		D	High temperature caution label	DCE622	06/09
103	PSPA20054QSZZ	-	AF		C	Mylar sheet	DCE644	-
501	CPLTP0060RS52		AR		E	Reverse gate unit		
	(Unit)							
901	DUNTW0524RSZZ		BU		E	Fusing unit (120V series)		
901	DUNTW0524USZZ	1	BU	N	E	Fusing unit (120V series)		07/06
901	DUNTW0524RS12		BV		E	Fusing unit (230V series)		
901	DUNTW0524US12	1	BV	N	E	Fusing unit (230V series)		07/06

9 Fusing unit

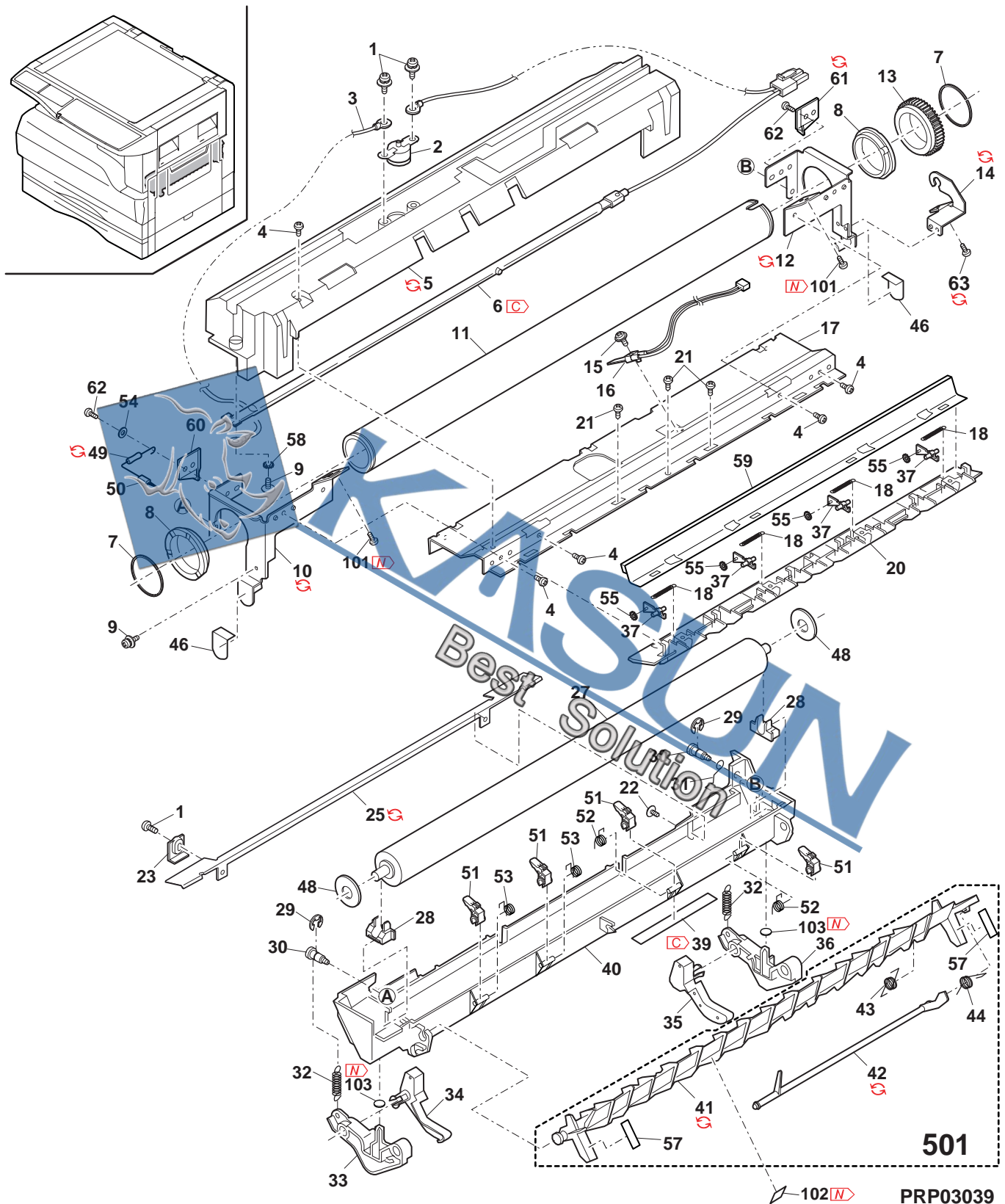

– 10-1 –

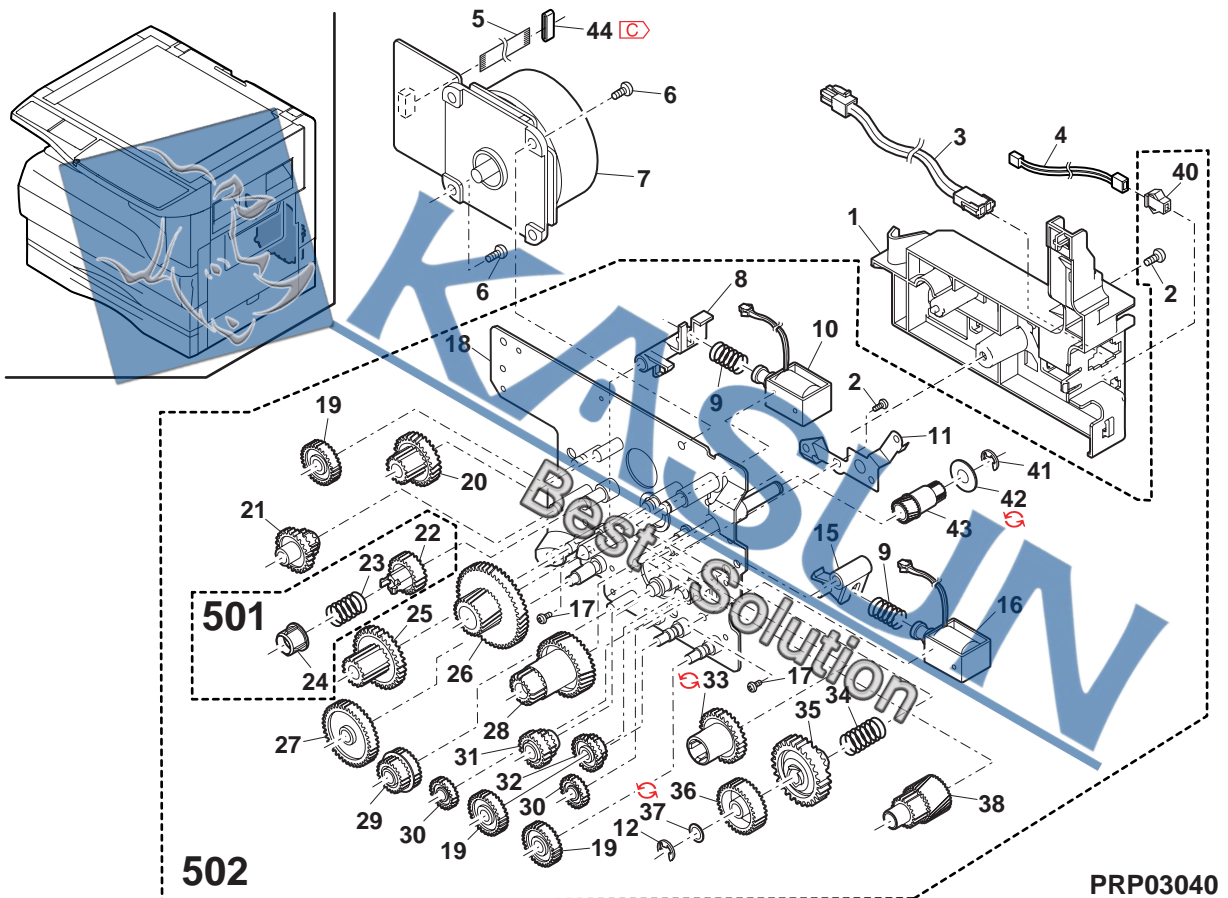
10 Main driving unit

- 11-1 -

11 Base plate unit 1

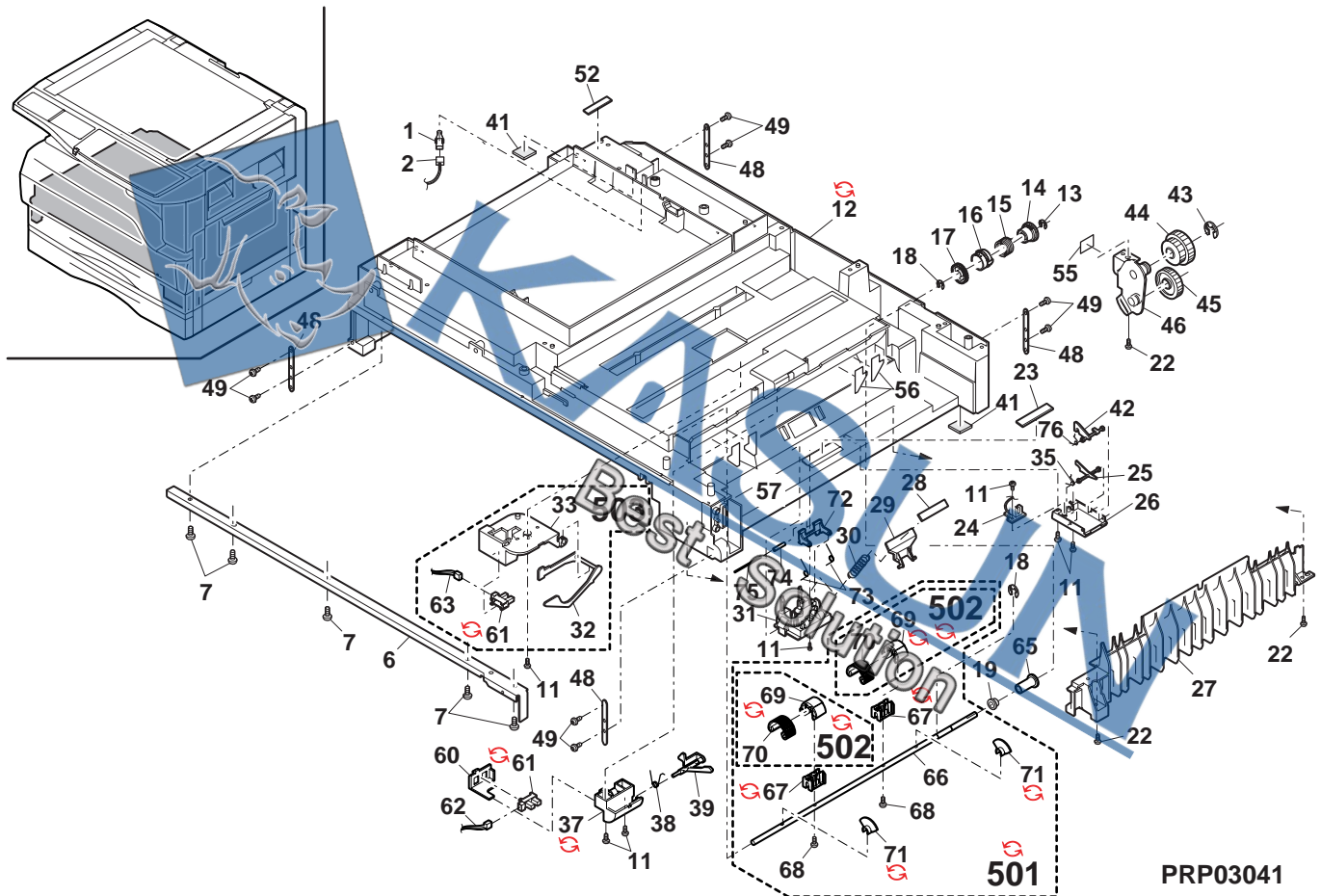

12 Base plate unit 2

NO.	PARTS CODE	Inter-change	PRICE RANK	NEW MARK	PART RANK	DESCRIPTION	TR No.	Effective time
1	LSOU-0036QSZZ		BA		D	Delivery tray		
	LSOU-0036QSZ2	1	BA		D	Delivery tray		- R/C
2	GCAB-0069QSZZ		AT		D	Delivery rear cover		
	GCAB-0069QSZ1	1	AT		D	Delivery rear cover		- R/C
3	XEBS740P10000		AA		C	Screw(4x10)		
5	CPWBF0114QSE8		AZ		E	I/F PWB (U.S.A,Canada)		
	CPWBF0114QSE9		AZ	N	E	I/F PWB (Except U.S.A,Canada)		
6	NFANP0010QSPZ		AQ		B	PS fan [AR-M162E/AR-M207E]		
	NFANP0010QSZZ		AS		B	PS fan [Other Model]		
	NFANP0010QSPZ	3	AQ		B	PS fan [Unleaded correspondence][Other Model]		06/02
7	XBPS730P32KS0		AC		C	Screw(3x32KS)		
	RDENC0015QS11		BV		E	Low voltage power supply unit (120V series)		
	RDENC0015QS12		BV		E	Low voltage power supply unit (230V series Except South Africa)		
8	RDENC0019QS12	1	BZ		E	Low voltage power supply unit (230V series Except South Africa)		07/10 R/C
	RDENC0015QS138	-	BY	N	E	Low voltage power supply unit [Missing parts code][AR-M162/AR-M207(Taiwan)]		1st lot
9	QSW-C9292QCPZ		AN		B	AC switch		
10	XBPS730P08KS0		AB	N	C	Screw(3x8KS)		
11	RDENC0017QSZZ		BE		E	High voltage power supply unit		
	RDENC0017QSZ1	1	BU	N	E	High voltage power supply unit (Except Taiwan,South Africa)		07/10
12	LPLTM0082QSZ7		AF		C	PS PWB fixing plate		
13	XHBS730P06000		AC		C	Screw(3x6)		
14	LFRM-0067QSZZ		AK		C	Corner frame FL		
15	XEBS740P12000		AA		C	Screw(4x12)		
16	LFRM-0068QSZZ		AQ		C	Corner frame RL		
17	XBPSN40P06K00		AA		C	Screw(4x6K)		
	QACCDR614QCPZ		AS		B	AC cord (U.S.A,Canada)		
	QACCBR421QCPZ		AZ		B	AC cord (U.kingdom)		
	QACCLH421QCPZ		AW		B	AC cord (Australia,New Zealand)		
	QACCEB624QCPZ		AW		B	AC cord (Germany,Switzerland,STCL,France,Holland,Spain,Italy,Denmark,Finland,Norway)		
18	QACCCR411QCPZ	-	AW		B	AC cord [Missing parts code][AR-M162/AR-M207(Taiwan)]		1st lot
	QPLGA0009QCZZ		AS		B	Plug (Hong Kong,Singapore)		
	QPLGA0009QCPZ	3	AR	N	B	Plug [Unleaded solder correspondence](Hong Kong,Singapore)		06/02
	QPLGA4171CCZZ		AN		B	Plug (South Africa)		
	QPLGA4171CCPZ	3	AR	N	B	Plug [Unleaded solder correspondence](South Africa)		06/02
	PHOG-1023CCZZ		AB		C	Plug protector [AR-M161/AR-M206 Except STCL]		
19	DHAi-0122QSZ1		AK		C	AC switch harness		
20	LX-BZ0705FCPZ		AC		C	Screw [AR-M162(Australia,New Zealand)/AR-M162E/AR-M165/AR-M207(Europe)/AR-M207E]		
21	LPLTM0308QSZZ		AL		C	Corner frame R reinforce plate		
22	GDAi-0002QSE1		BF		D	Base plate		
	GDAi-0002QSE2	1	BF		D	Base plate		- R/C
23	LFRM-0025QSZ3		AH		C	Corner frame FR		
24	LPLTM0099QSZ2		AK		C	Corner frame R reinforce plate		
25	LFRM-0026QSZ2		AN		C	Corner frame RR		
26	XHBS730P14000		AA	N	C	Screw(3x14)		
27	XEBS730P10000		AC		C	Screw(3x10)		
28	LX-BZ0700FCPZ		AB		C	Screw(4x12)		
29	XHBS730P08000		AB		C	Screw(3x8)		
30	CPLTM0071QS03		AF		C	Drive joint plate [AR-M161/AR-M162/AR-M162E]		
31	LPLTM0347QSZZ		AG		C	Net box fixing plate		
32	XHBS730P08000		AB		C	Screw(3x8)		[AR-M161/AR-M162/AR-M162E]
33	LX-BZ0031QSPZ		AE		C	Screw		
	LX-BZ0090QSPZ	1	AE		C	Screw		07/09
35	LX-BZ0750FCPZ		AA		C	Screw(3x6)		
	LX-BZ0088QSPZ	1	AA		C	Screw(3x6)		07/09
36	NBLTT0007QSZZ		AH		B	Delivery roller drive belt [AR-M161/AR-M162/AR-M162E]		
	CPWBX0175QS32		CC		E	MCU PWB [AR-M161/AR-M162/AR-M162E]		
	CPWBX0175QS12	1	CL	N	E	MCU PWB [AR-M161/AR-M162/AR-M162E]		06/06
	CPWBX0175QSA2	1	CL	N	E	MCU PWB [AR-M161/AR-M162/AR-M162E]		07/03 R/C
	CPWBX0175QS36		CD		E	MCU PWB [AR-M165]		
	CPWBX0175QS16	1	CL	N	E	MCU PWB [AR-M165]		06/06
	CPWBX0175QSA6	1	CL	N	E	MCU PWB [AR-M165]		07/03 R/C
	CPWBX0175QS31		CD		E	MCU PWB [AR-M206/AR-M207(U.S.A,Canada,Australia,New Zealand)/AR-M207E]		
37	CPWBX0175QS11	1	CL	N	E	MCU PWB [AR-M206/AR-M207(U.S.A,Canada,Australia,New Zealand)/AR-M207E]		06/06
	CPWBX0175QSA1	1	CL	N	E	MCU PWB [AR-M206/AR-M207(U.S.A,Canada,Australia,New Zealand)/AR-M207E]		07/03 R/C
	CPWBX0175QS39		CG		E	MCU PWB [AR-M207 Europe]		
	CPWBX0175QS19	1	CL	N	E	MCU PWB [AR-M207 Europe]		06/06
	CPWBX0175QSA9	1	CL		E	MCU PWB [AR-M207 Europe]		07/03 R/C
	CPWBX0175QSC8	-	CC	N	E	MCU PWB [Missing parts code][AR-M162(Taiwan)]		07/03 R/C
	CPWBX0175QSC7	-	CC	N	E	MCU PWB [Missing parts code][AR-M207(Taiwan)]		07/03 R/C
39	GCOV-0066QSZZ		AC		C	Frame cover		
40	LPLTM0307QSZ1		AL		C	Delivery left cover		
41	LPLTM0309QSZZ		AE		C	Optical adjustment plate		
42	LX-BZ0039QSPZ		AB		C	Screw(4x10)		

12 Base plate unit 2

NO.	PARTS CODE	Inter-change	PRICE RANK	NEW MARK	PART RANK	DESCRIPTION	TR No.	Effective time
43	XHBS730P08000		AB		C	Screw(3x8)		
44	LBNDJ0037FCZ1		AA		C	Cable band		
45	LHLDW0086QSZZ		AB		C	Harness ring		
46	XEBS730P18000		AB		C	Screw(3x18) (200V series)		
47	XWSS730-07000		AA	N	C	Washer (200V series)		
48	XWHS730-05080		AA	N	C	Washer (200V series)		
49	QTANN0015FCZZ		AG		C	3P terminal base (200V series)		
50	QTANN0015FCPZ	3	AG	N	C	3P terminal base [Unleaded solder correspondence](200V series)		06/02
51	DHAi-0140QSZ1		AH		C	AC harness (200V series)		
52	DHAi-0320QSZZ		AN		C	PS harness		
53	LFIX-0016FCZZ		AD		C	AC cord holder		
54	XEPS740P30000		AC		C	Screw(4x30)		
55	XEBS740P12000		AA		C	Screw(4x12)		
56	XWSS740-10000		AA	N	C	Washer		
57	XWHS740-08100		AA	N	C	Washer		
58	DHAi-0328QSZZ		AH		C	IF-MCU harness		
60	LPLTM0382QSZZ		AR		C	MCU fixing plate		
61	LPLTM0306QSZ1		AL		C	Optical reinforce plate		
64	PSHEZ0135QSZZ		AC		C	Drive plate sheet [AR-M161/AR-M162/AR-M162E/AR-M206(South Africa)]		
65	XWHS740-08100		AA	N	C	Washer [AR-M161/AR-M162/AR-M162E/AR-M206(South Africa)]		
66	XEBS730P08000		AC		C	Screw(3x8)		
67	PSHEZ0421QSZZ		AC		C	MCU edge protect sheet		
68	CSW-M0007SS55		AS		B	Interlock switch unit		
69	PSHEZ0408QSZZ		AC		C	Interlock switch maintenance sheet		
70	LPLTM0303QSZZ		AE		C	Interlock switch fixing plate		
71	XBPS720P09000		AB		C	Screw(2x9)		
72	XWHS720-07043		AA	N	C	Washer		
73	PSHEZ0448QSZZ		AA		C	Optical base plate bottom sheet B		
74	RCORF0018QSZZ		AR		C	Ferrite core (Except Taiwan,South Africa)		
75	RCORF0026QSZZ		AE		C	Ferrite core (Except Taiwan,South Africa)		08/01
76	RCORF0027QSZZ		AN		C	I/F FFC core [Missing parts code][AR-M162/AR-M206/AR-M207(Taiwan)]		1st lot
77	DHAi-0342QSZZ		AG		C	CCD harness		
78	RCORF0018QSZZ		AR		C	Ferrite core		
79	PDUC-0006QSZ1		AF		C	Duct		
80	PFILZ0013QSZZ		AR		A	Ozone filter		
81	PFILZ0013QSZ1	1	AR	N	A	Ozone filter		07/04 R/C
82	PFILZ0021QSZZ	1	AR		A	VOO ozone filter		08/02
83	PSHEZ0496QSZZ		AD		C	LSO harness protect sheet		
84	PSHEZ0497QSZZ		AB		C	MCU sensor receive sheet		
85	CPWBX0130QS34		CD		E	IMC2 PWB [AR-M162(Australia,New Zealand)/AR-M162E/AR-M165/AR-M207(Europe,Australia,New Zealand)/AR-M207E]		
86	CPWBX0130QS35	-	CA	N	E	IMC2 PWB [Missing parts code][AR-M162/AR-M207(Taiwan)]		1st lot
87	LHLDW1009ACZZ		AA		C	Clamp		
88	LPLTM0315QSZZ		AL		C	ERDH fixing plate [AR-M162(Australia,New Zealand,Taiwan)/AR-M162E/AR-M165/AR-M207(Europe,Taiwan)/AR-M207E]		
89	DHAi-0329QSZZ		AD		C	IMC IN harness [AR-M162(Australia,New Zealand,Taiwan)/AR-M162E/AR-M165/AR-M207(Europe,Taiwan)/AR-M207E]		
90	DHAi-0330QSZZ		AD		C	IMC OUT harness [AR-M162(Australia,New Zealand,Taiwan)/AR-M162E/AR-M165/AR-M207(Europe,Taiwan)/AR-M207E]		
91	PSHEZ0140QSZ1		AE		C	3P terminal base sheet (200V series)		
92	TLABH0602QSZ1		AB		D	USB-1 label		
93	XHBS730P08000		AB		C	Screw(3x8)		
94	RMOTS0054QSPA		AT		B	DUP motor [AR-M207E]		
95	RMOTS0042QSZZ		AT		B	DUP motor [AR-M165/AR-M206/AR-M207]		
96	RMOTS0042QSPZ	3	AT	N	B	DUP motor [Unleaded correspondence][AR-M165/AR-M206/AR-M207]		06/02
97	CPLTM0073QS01		AM		C	DUP motor fixing plate [AR-M165/AR-M206/AR-M207/AR-M207E]		
98	NBRGC0529FCZZ		AD		C	Bearing [AR-M165/AR-M206/AR-M207/AR-M207E]		
99	NGERH0065QSZZ		AC		C	Gear(21-28T) [AR-M165/AR-M206/AR-M207/AR-M207E]		
100	NGERH0064QSZZ		AD		C	Gear pulley(40T24T) [AR-M165/AR-M206/AR-M207/AR-M207E]		
101	XRESP40-06000		AA		C	E type ring(E4) [AR-M165/AR-M206/AR-M207/AR-M207E]		
102	NGERH0075QSZZ		AC		C	Gear(20T) [AR-M165/AR-M206/AR-M207/AR-M207E]		
103	NPLYZ0011QSZZ		AC		C	Pulley [AR-M165/AR-M206/AR-M207/AR-M207E]		
104	NBLTT0009QSZZ		AG		B	DUP driving belt(134) [AR-M165/AR-M206/AR-M207/AR-M207E]		
105	NBLTT0008QSZZ		AG		B	DUP roller driving belt [AR-M165/AR-M206/AR-M207/AR-M207E]		
106	NPLYZ0008QSZZ		AC		C	Pulley(S2M20T) [AR-M165/AR-M206/AR-M207/AR-M207E]		
107	PSHEZ0065QSZZ		AB		C	Pulley flange sheet [AR-M165/AR-M206/AR-M207/AR-M207E]		
108	MSPRC1315FCZ1		AD		C	Clutch spring A [AR-M165/AR-M206/AR-M207/AR-M207E]		
109	XRESP40-06000		AA		C	E type ring(E4) [AR-M165/AR-M206/AR-M207/AR-M207E]		
110	NGERH0066QSZZ		AD		C	Gear(17T) [AR-M165/AR-M206/AR-M207/AR-M207E]		
111	CPLTM0103QS02		AF		C	DUP driving idle plate [AR-M165/AR-M206/AR-M207/AR-M207E]		
112	LHLDZ0110QSZZ		AG		C	Connector holder		
113	DHAi-0403QSZZ		AG		C	NWAC I/F 1 harness		
114	TLABZ4868FCZZ		AC		D	Ground label (200V series)		
115	TLABZ4868FCZ1	1	AB	N	D	Ground label (200V series)		06/12
116	LPLTM0360QSZZ		AC		C	Earth plate		

12 Base plate unit 2

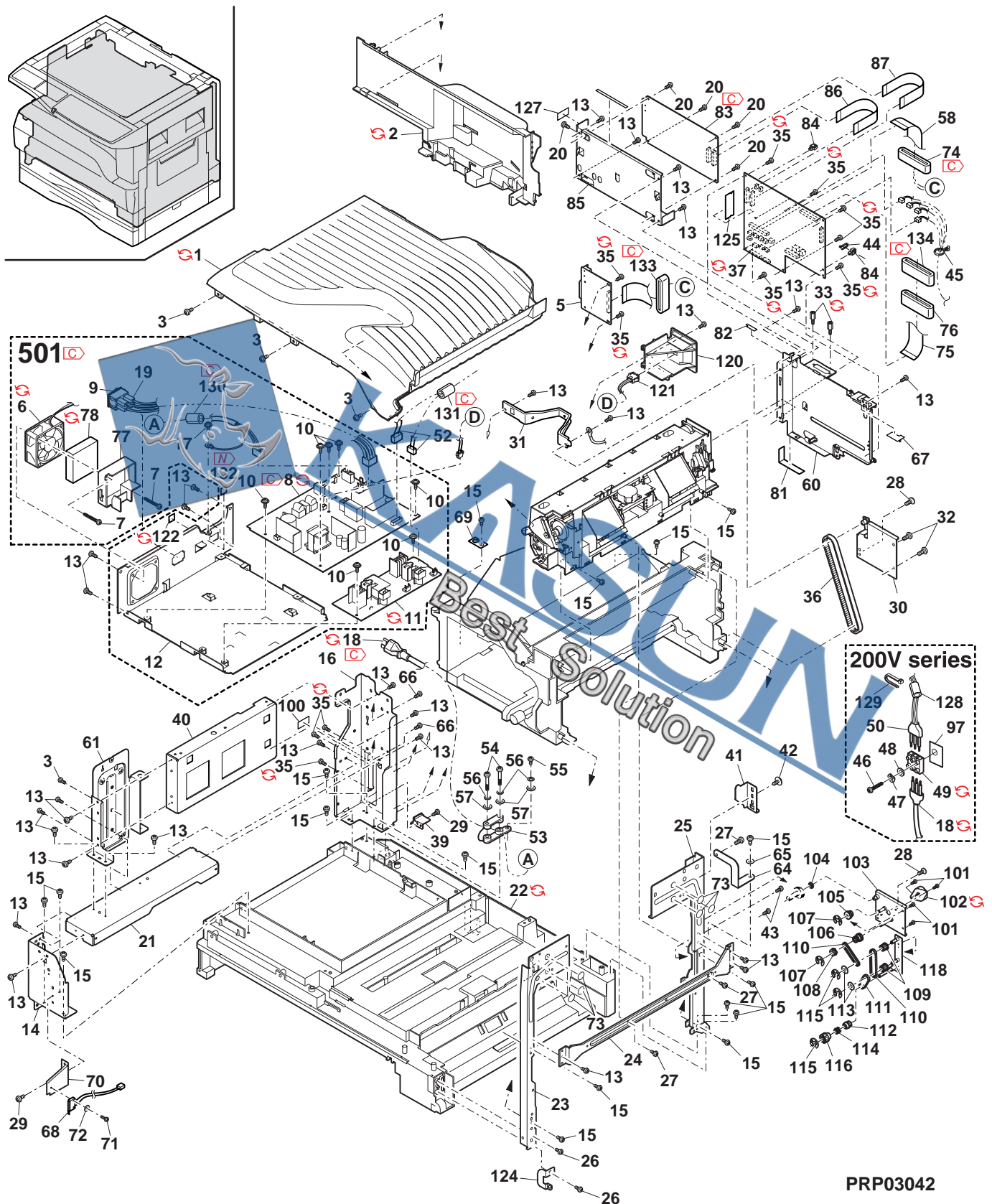

PRP03042

- 13-1 -

13 Manual paper feeding multi unit

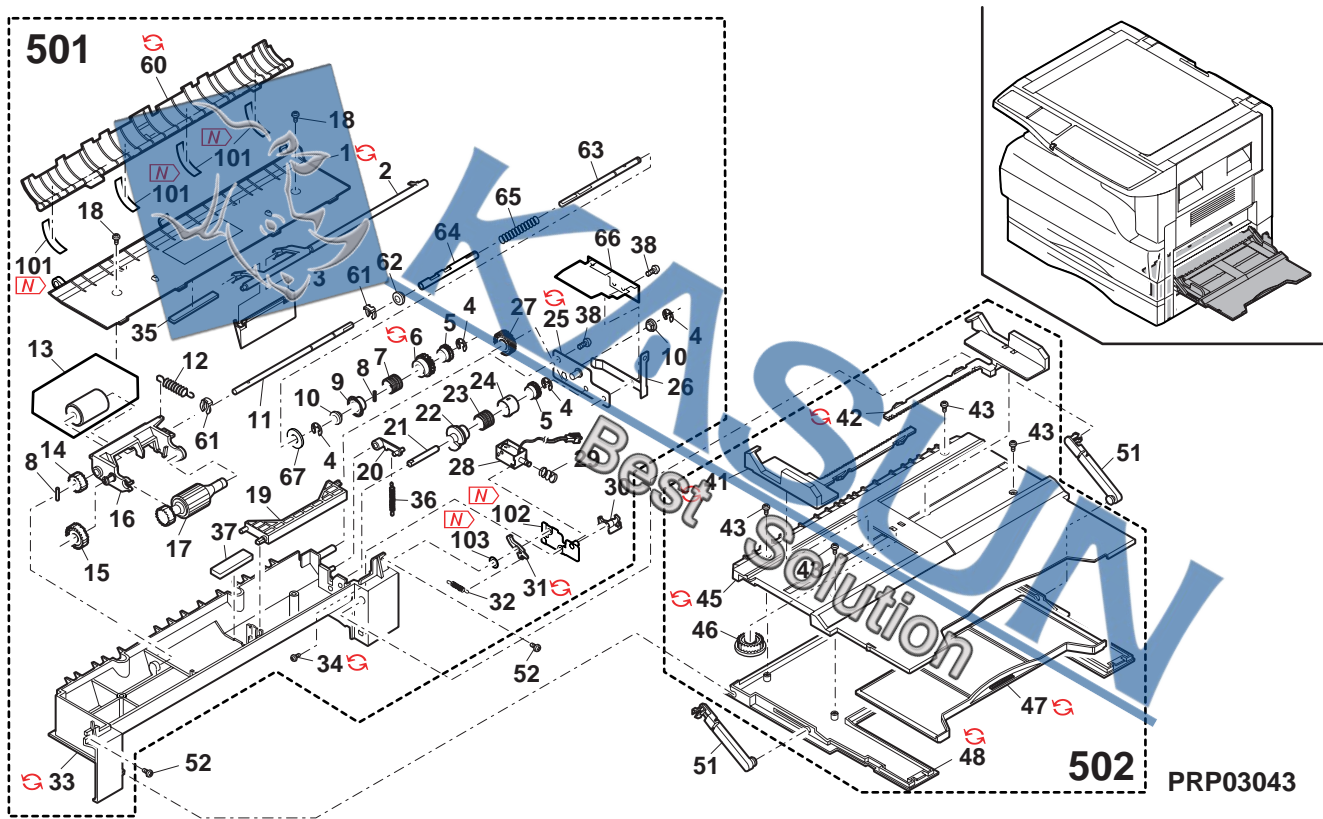

14 Delivery frame unit

NO.	PARTS CODE	Inter-change	PRICE RANK	NEW MARK	PART RANK	DESCRIPTION	TR No.	Effective time
1	XEBS730P08000		AC		C	Screw(3x8)		
2	GCOV-0065QSZZ		AN		C	Delivery front side cover		
3	CPWBF0179QSE1		AX		E	Tray PWB		
4	XEBS730P06000		AA		C	Screw(3x6)		
5	PSPO-0030QSZZ		AC		C	Cushion		
6	NROLM0124QSZ1		AP		C	Delivery roller		
7	MSPRT0229GCAZ		AC		C	FU spring R		
8	NROLP0123QSZZ		AH		C	Delivery follower roller B		
9	NKOM-0002QSZZ		AC		C	Delivery collar		
10	CPWBF0147QSF1		AL		E	P-OUT sensor PWB		
11	PBRSR0009QSZ1		AH		B	Discharge brush [AR-M161/AR-M162/AR-M162E]		
	PBRSR0005QSZZ		AK		B	Discharge brush [AR-M165/AR-M206/AR-M207/AR-M207E]		
12	XRESP50-06000		AA		C	E type ring(E5)		
13	NBRGC0529FCZZ		AD		C	Bearing		
14	LPLTM0100QSZZ		AD		C	Delivery earth plate B		
15	NBRGY2122SCZZ		AB		B	Transport roller bearing 1		
16	LHLDZ0040QSZZ		AS		C	Delivery roller holder		
17	XEBS730P14000		AD	N	C	Screw(3x14)		
18	LBOSZ0048QSZZ		AC		C	Separator lever boss		
19	MLEVP0028QSE1		AD		C	Separator lever F		
20	LPINS0001QSZZ		AA		C	Pin		
21	NGERH0076QSZZ		AD		C	Separator cam gear		
22	XRESP50-06000		AA		C	E type ring(E5)		
24	NSFTZ0025QSP1		AM		C	Separator drive shaft		
25	MCAMP0002QSZZ		AE		C	Separator drive cam		
26	MLEVP0027QSZZ		AD		C	Separator lever R		
27	MLEVP0110QSZZ		AD		C	Separator lever R		08/02 R/C
28	MLEVP0106QSZZ		AD		C	FULL detection lever		
29	CPWBF0147QSF2		AL		E	Delivery actuator		
30	MSPRD0143QSZZ		AF		C	DUP sensor PWB		
	MSPRD0143QSZZ		AF		C	Delivery earth spring A		
31	NPLYZ0030QSZZ		AE		C	Delivery pulley [AR-M161/AR-M162/AR-M162E]		
	NGERH0063QSZZ		AD		C	Delivery drive gear(30T) [AR-M165/AR-M206/AR-M207/AR-M207E]		
32	LPINS0258FCZZ		AA		C	Spring pin(φ3-8)		
33	NBRGC0019QSZZ		AD		C	Bearing(φ6)		
34	XRESP40-06000		AA		C	E type ring(E4) [AR-M165/AR-M206/AR-M207/AR-M207E]		
35	NGERH0070QSZZ		AC		C	DUP delivery R gear(20T) [AR-M165/AR-M206/AR-M207/AR-M207E]		
36	XPSSJ20-10000		AA		C	Spring pin(φ2-10) [AR-M165/AR-M206/AR-M207/AR-M207E]		
37	NBRGY2122SCZZ		AB		B	Transport roller bearing 1 [AR-M165/AR-M206/AR-M207/AR-M207E]		
38	NROLP0038QSZZ		AP		C	DUP delivery roller [AR-M165/AR-M206/AR-M207/AR-M207E]		
39	LFRM-0027QSZZ		AV		C	Delivery frame		
	LFRM-0027QSZZ	1	AV		C	Delivery frame		06/04
	PFILZ0004QSZZ		AM		A	Ozone filter		
40	PFILZ0004QSZZ	1	AM	N	A	Ozone filter		07/04 R/C
	PFILZ0017QSZZ	1	AP		A	Ozone filter VOC2		08/02
41	PMLT-0099QSZZ		AC		C	Cooling fan cushion		
42	XEBS720P06000		AC		C	Screw(2x6)		
	LX-BZ0095QSZZ	1	AA		C	Screw(2x6)		08/04
	NFANP0009QSPZ		AS		B	Cooling fan [AR-M162E/AR-M207E]		
43	NFANP0009QSZZ		AT		B	Cooling fan [Other Model]		
	NFANP0009QSPZ	3	AS		B	Cooling fan [Unleaded correspondence]		06/02
44	PDUC-0003QSZZ		AG		C	Cooling fan duct		
45	PGIDM0062QSZZ		AK		D	Delivery upper paper guide 20		
46	NROLP1122FCZZ		AF		C	PS upper roller [AR-M165/AR-M206/AR-M207/AR-M207E]		
47	PGIDM0040QSZZ		AK		C	Delivery lower paper guide		
48	MSPRT0229GCAZ		AC		C	FU spring R [AR-M165/AR-M206/AR-M207/AR-M207E]		
50	XEBS730P08000		AC		C	Screw(3x8)		
51	CSFTZ0023QS02		AH		C	Shifter shaft		
52	MSPRD0144QSZZ		AC		C	Delivery earth spring B		
53	XRESP40-06000		AA		C	E type ring(E4)		
54	LSTPP0003QSZZ		AC		C	Shifter stopper		
55	MSPRT0107QSZZ		AC		C	Shifter return spring		
56	NGERH0067QSZZ		AD		C	Shifter gear(24T)		
57	NGERH0068QSZZ		AD		C	Shifter gear(50T)		
58	CPLTM0075QS02		AG		C	Shifter drive plate		
	RMOTS0053QSPA		AR		B	Shifter motor [AR-M162E/AR-M207E]		
59	RMOTS0040QSZZ		AR		B	Shifter motor [Other Model]		
	RMOTS0040QSPZ	3	BC	N	B	Shifter motor [Unleaded correspondence][Other Model]		06/02
60	XHBS830P05000		AA		C	Screw(3x5)		
61	CPWBF0147QSE3		AL		E	Shifter HP sensor PWB		
62	XRESP30-06000		AA		C	E type ring(E3)		
64	DHAI-0480QSZZ		AF		C	Delivery tray unit harness		
71	NROLP0122QSZZ		AH		C	Delivery follower roller A		
73	XHBS730P08000		AB		C	Screw(3x8)		
77	DUNT-0513RSZZ		AT		E	JOB separator minimum unit		
78	DHAI-0489QSZZ		AC		C	JOB separator switch harness		
79	LPLTM0147QSZZ		AD		C	Minimum sensor fixing plate		
80	LX-BZ7062XCPZ		AA		C	Screw		
87	LPLTP0385QSZZ		AD		C	Delivery fixing plate		

14 Delivery frame unit

NO.	PARTS CODE	Inter-change	PRICE RANK	NEW MARK	PART RANK	DESCRIPTION	TR No.	Effective time
	(Unit)							
901	CFRM-0027RS79		BT		E	Delivery frame unit SIMP [AR-M161/AR-M162/AR-M162E]		
	CFRM-0027RS77		BU		E	Delivery frame unit DUP [AR-M165/AR-M206/AR-M207/AR-M207E]		

14 Delivery frame unit

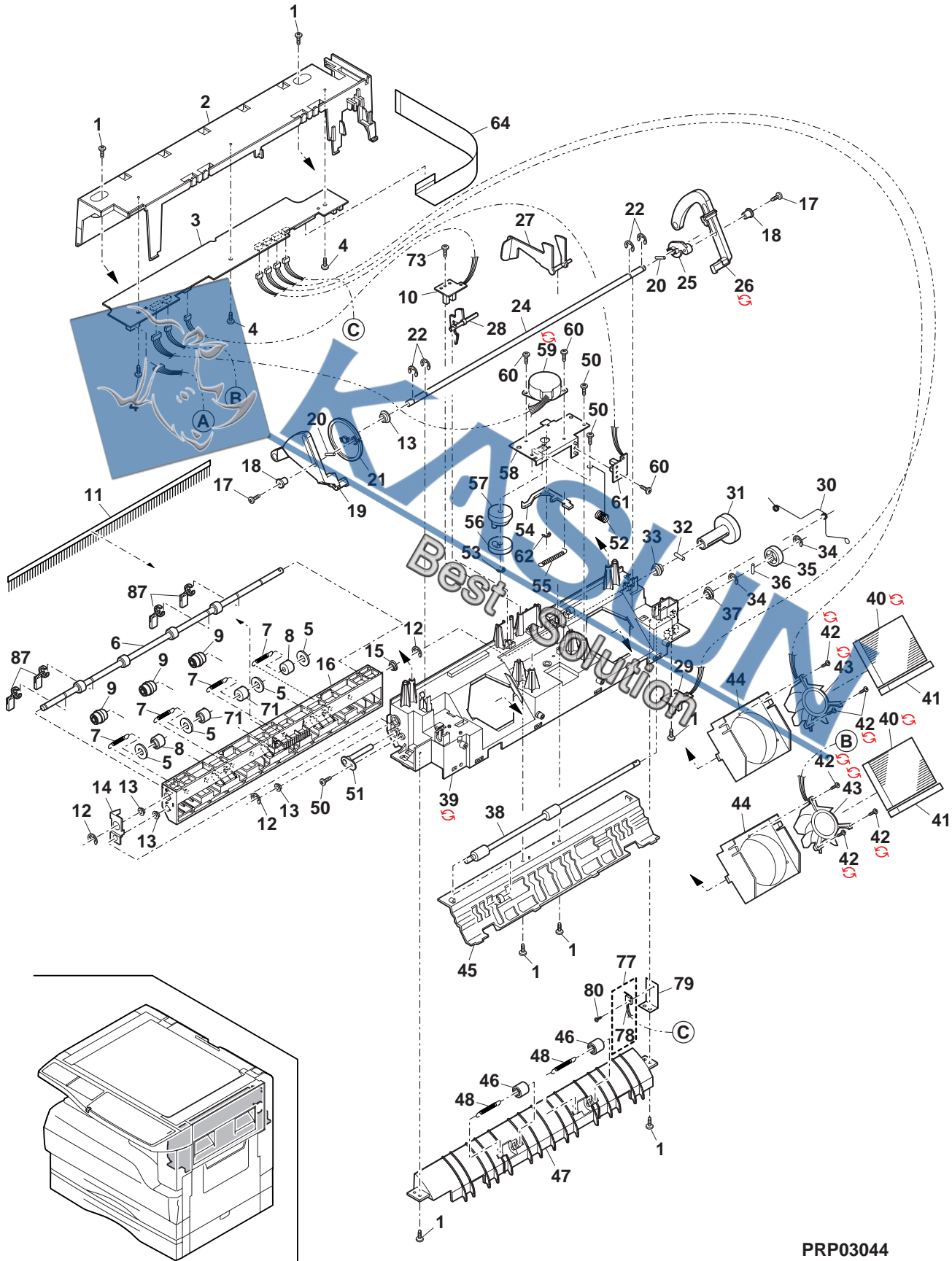

PRP03044

15 TC case unit

NO.	PARTS CODE	Inter-change	PRICE RANK	NEW MARK	PART RANK	DESCRIPTION	TR No.	Effective time
1	XEBS730P08000		AC		C	Screw(3x8)		
2	PGIDH0118QSZZ		AK		C	TC front guide		
3	PSHEP0050QSZ1		AD		C	TC sheet		
5	PSHEP0051QSZZ		AB		C	TC cover sheet F		
6	LHLDZ0030QSZZ		AD		C	TC holder F		
7	DWIR-0466CSZZ		BE		B	Charger wire		
8	MSPRT0513FCZ1		AA		C	MC tension spring		
9	PSHEP0052QSZZ		AB		C	TC cover sheet R		
10	LHLDZ0032QSZZ		AD		C	TC holder R		
11	QSLP-0009QSZZ		AD		C	TC electrode plate		
12	PCASZ0013QSZZ		AP		C	TC case		
13	LHLDZ0031QSZZ		AH		C	Discharge holder		
14	QSLP-0008QSZZ		AD		C	BC electrode plate		
16	PGIDM0032QSZZ		AE		C	Separator guide		
17	XEBS730P06000		AA		C	Screw(3x6)		
19	PSHEZ0125QSZZ		AE		C	Discharge delivery sheet		
20	PSHEZ0434QSZZ		AC		C	TC case sheet		
21	DUNTK0233QSPZ		AH	N	E	Resistor unit transfer		
22	XBPS030P06K00		AA		C	Screw(3x6K)		
23	PSHEZ0435QSZZ		AA		C	Guide sheet		
24	PSPAZ0040QSZZ		AB		C	Front guide spacer		
(Unit)								
901	CHLDZ0030RS55		AY		E	TC unit		

15 TC case unit

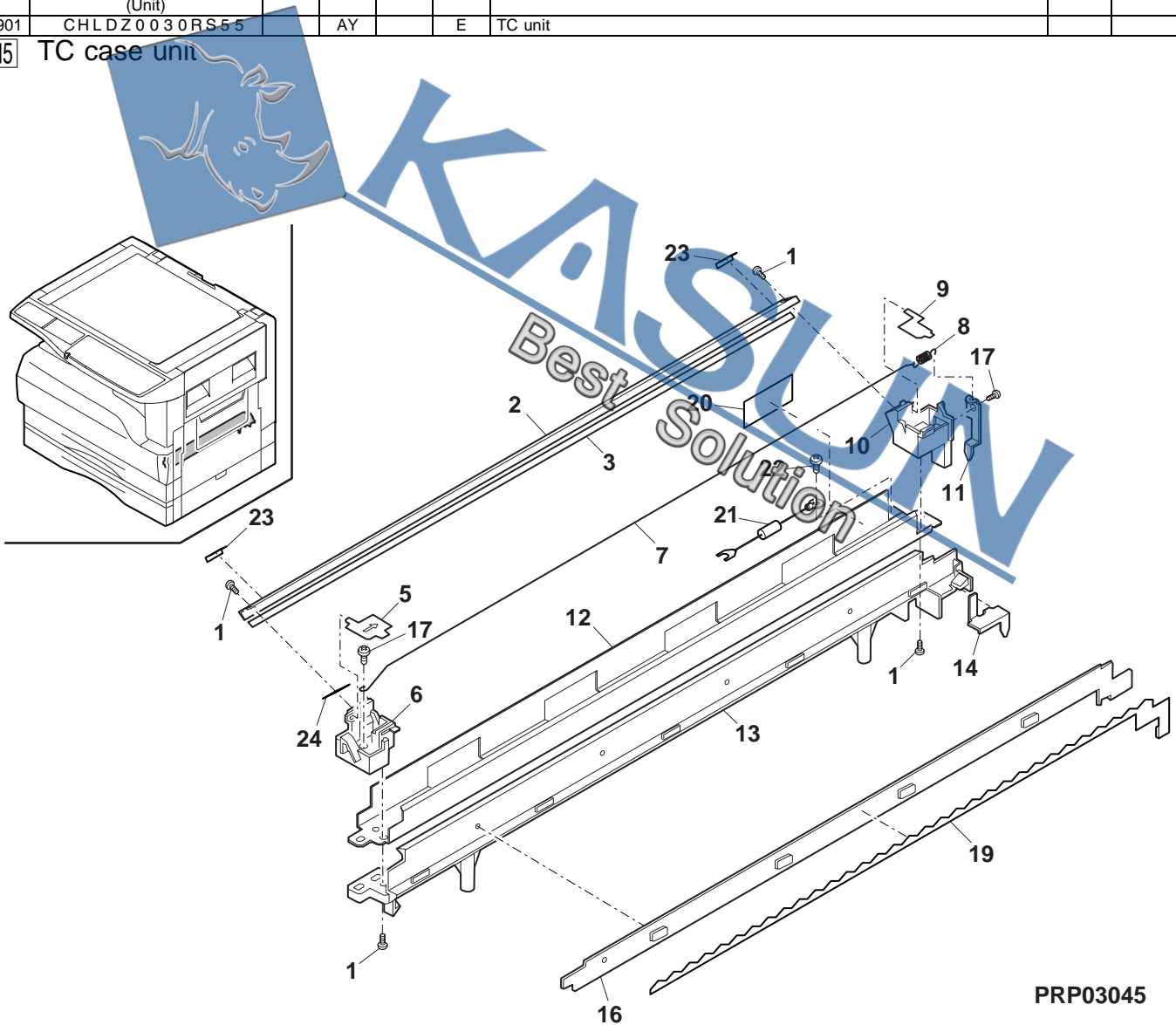

16 250 sheets tray unit

NO.	PARTS CODE	Inter-change	PRICE RANK	NEW MARK	PART RANK	DESCRIPTION	TR No.	Effective time
1	LPLTM0364QSZZ		AR		C	Rotation plate		
2	PSHEZ0441QSZZ		AD		C	Rotation plate sheet		
3	LHLDW1226FCZZ		AB		C	Turn fastener		
4	LPLTM2642FCG2		AD		C	Tray rear plate		
5	PGIDM0122QSZZ		AL		C	Guide F		
	PTME-0027QSZZ		AL		C	250 tray pawl F		
6	PTME-0027QSZZ3	-	AM		C	250 tray pawl F	DCE671	-
	PTME-0027QSZZ3	3	AM		C	250 tray pawl F (For Taiwan)	DCE650R	07/03
7	XRESP40-06000		AA		C	E type ring(E4)		
	TLABH0064QSZZ1		AC		D	Indicator label		
8	TLABH0064QSZZ2	1	AC		D	Indicator label	DCE645	07/03
9	PGIDM0123QSZZ		AL		C	Guide R		
	PTME-0028QSZZ		AL		C	250 tray pawl R		
10	PTME-0028QSZZ3	-	AM		C	250 tray pawl R	DCE671	-
	PTME-0028QSZZ3	3	AM		C	250 tray pawl R (For Taiwan)	DCE650R	07/03
	MSPRC0334QSZZ		AD		C	Tray spring		
11	MSPRC0090QSZZ	-	AD		C	Tray spring	DCE671	-
	MSPRC0090QSZZ	3	AD		C	Tray spring (For Taiwan)	DCE650R	07/03
12	XEBS730P08000		AC		C	Screw(3x8)		
13	XWHS730-08100		AA		C	Washer		
14	NGERH0193FCZZ		AB		C	UC manual feed gear		
15	MSPRC0152QSZZ		AB		C	Tray drawer lower spring D		
16	MSPRC1145FCZZ		AA		C	Stopper spring		
17	LSTPP0161FCZZ		AB		C	Rotation plate stopper		
18	GCASP0007QSZZ		AY		D	Tray case		
19	TTAG-0009QSZZ		AC		D	Tray rotation tag		
	JHNDP0007QSZZ		AS		C	Cassette panel		
20	JHNDP0007QSZZ1	1	AS		C	Cassette panel		- R/C
21	XEBS740P10000		AA		C	Screw(4x10)		
22	LPLTP0368QSZZ		AD		C	Cassette position block		
	(Unit)							
901	CCASP0007RS52		BL		E	250 sheets tray unit		

16 250 sheets tray unit

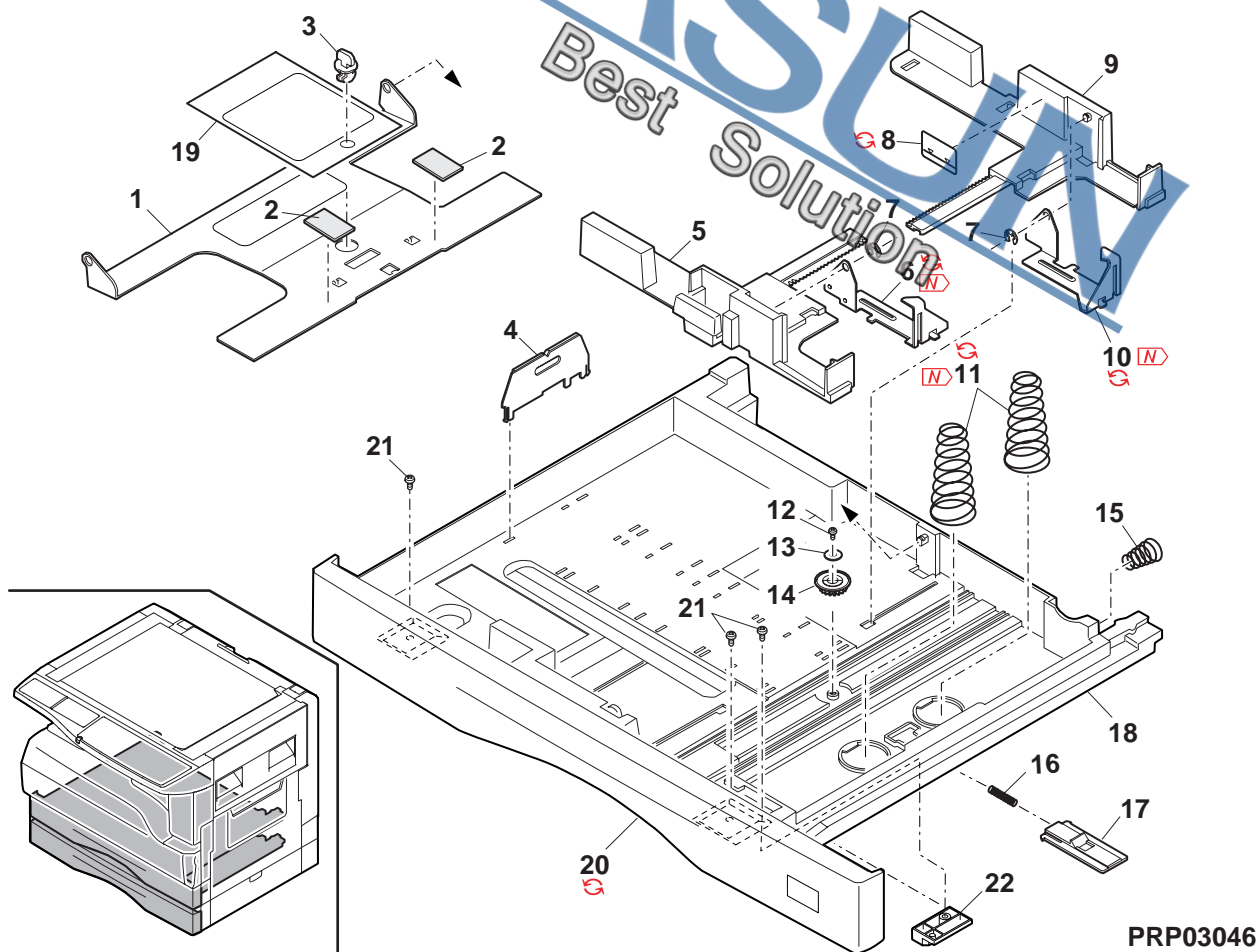

-17-1 -

17 Packing material & Accessories

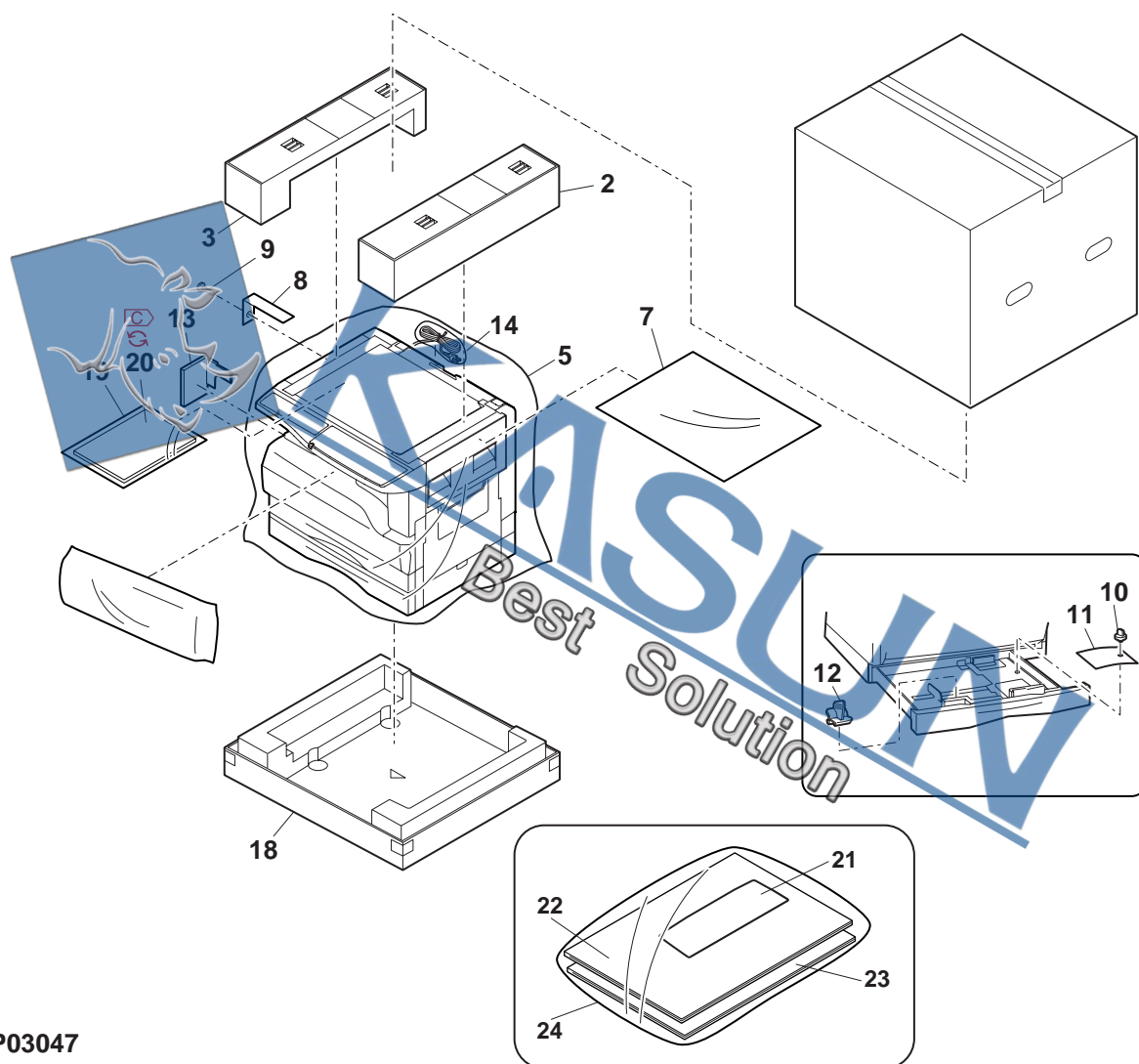

PRP03047

- 18-1 -

18 2nd Tray exteriors [AR-M206/AR-M207/AR-M207E]

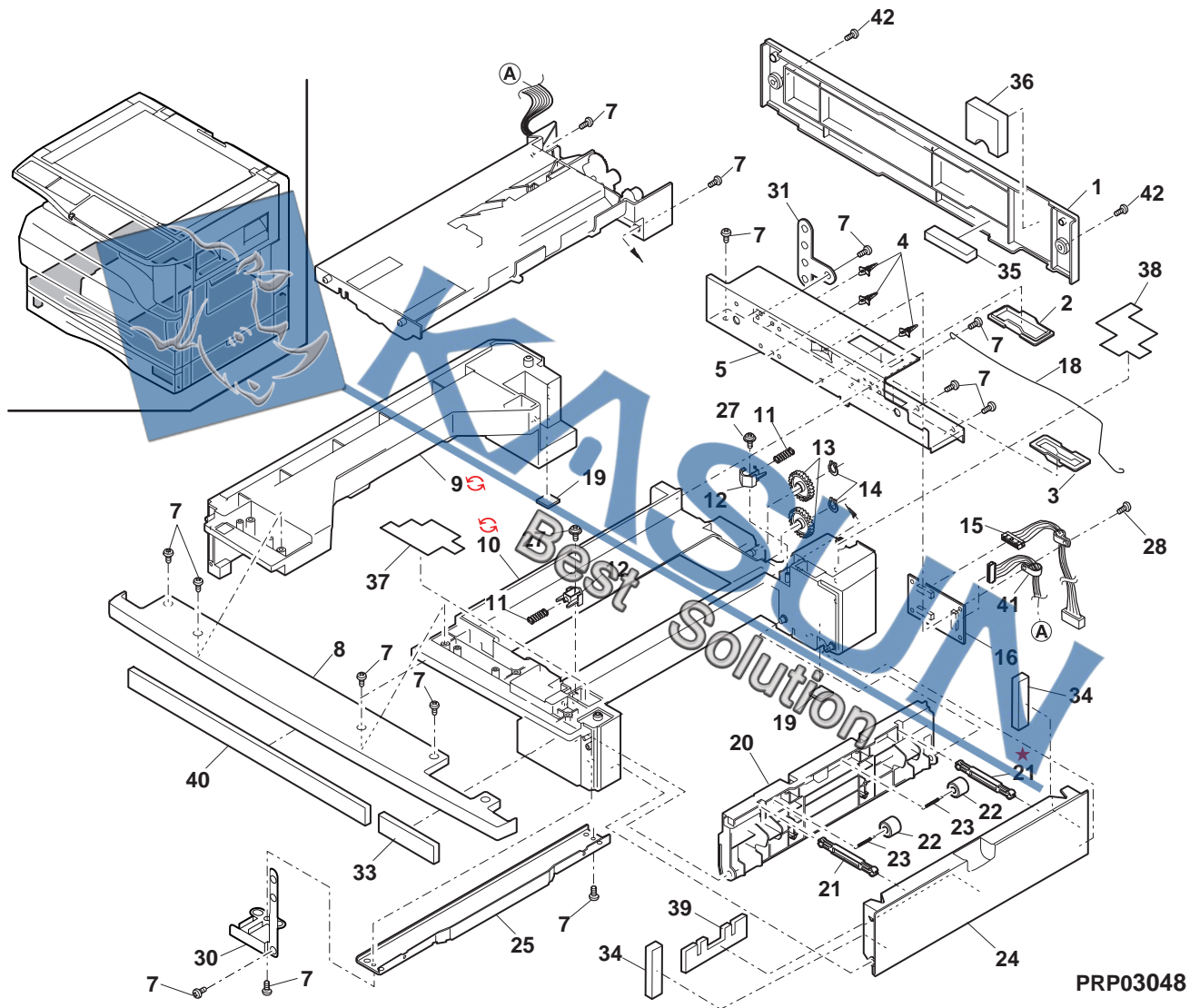

- 19-1 -

19 2nd Tray paper feeding unit [AR-M206/AR-M207/AR-M207E]

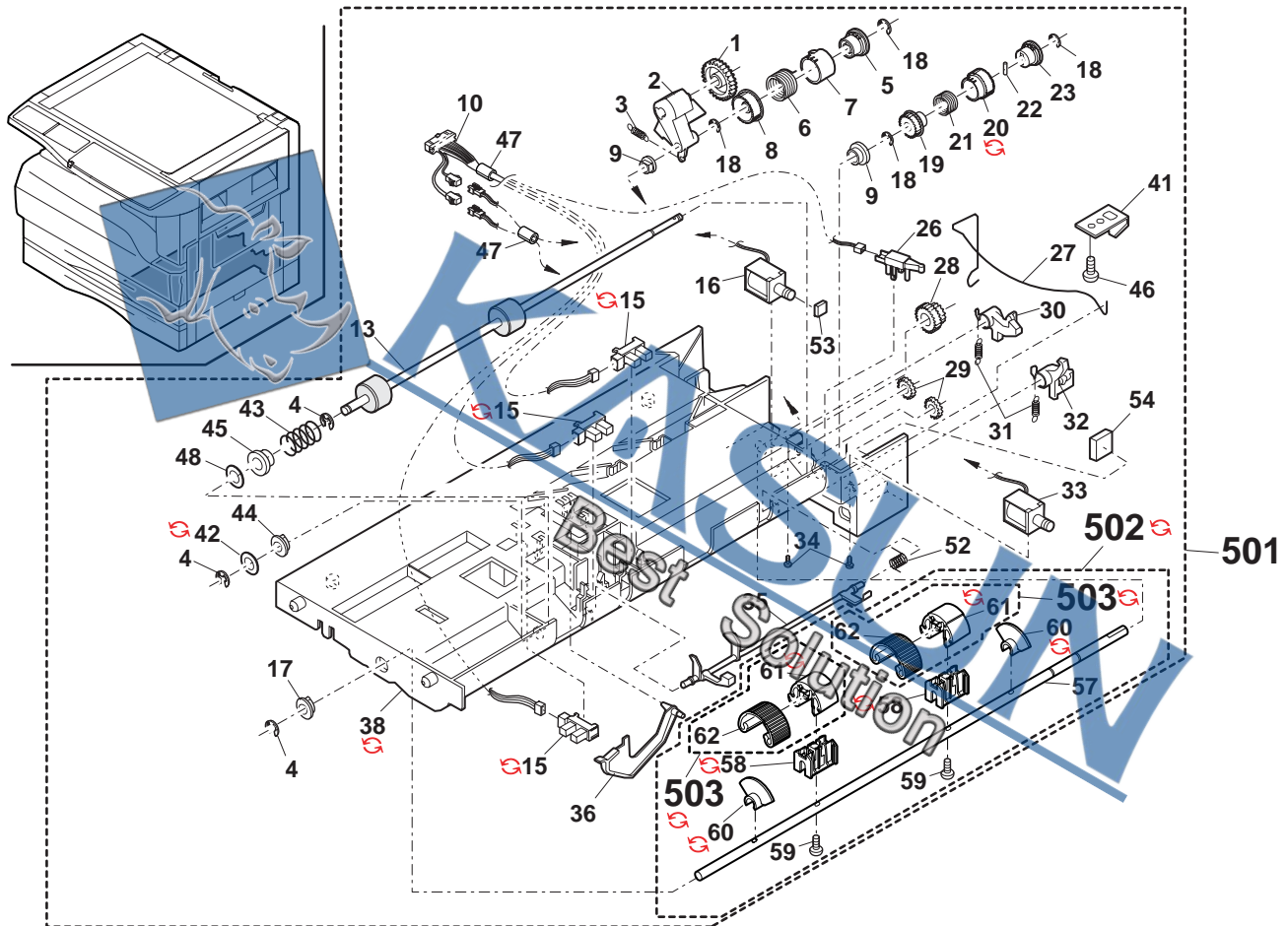

PRP03049



SHARP

COPYRIGHT © 2008 BY SHARP CORPORATION

All rights reserved.

Printed in Japan.

No part of this publication may be reproduced,
stored in a retrieval system, or transmitted.

In any form or by any means,
electronic, mechanical, photocopying, recording, or otherwise,
without prior written permission of the publisher.

SHARP CORPORATION
Digital Document System Group
CS Promotion Center
Yamatokoriyama, Nara 639-1186, Japan
2008 April Printed in Japan ⓘ